

Drilling scheme

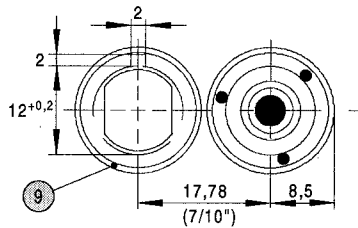

Original size

Table of contents

①	Base element	1
②	Internal socket with WBT double prism contact (active spring principle)	1
③	Double-wrap spring lock washer, bronze	1
④	3-hole-counternut	1
⑤	Internal insulation, red or white, PA	1
⑥	Dielectric, Teflon*	1
⑦	Space washer, PA, 1 mm	1
⑧	Spacer washer, PA, 2 mm	1
⑨	Step washer, PA, 3.5 mm	1
⑩	Double step washer with round hole, PA, 4.6 mm, red or white	1
⑪	Cylinder head screw M2,5 x 0,5 x 4 mm	1

Extent of delivery: 1-11 (parts 1-10 mounted)

Revision date : 25.04.1997

All rights reserved by WBT · Petty patent (DBGM8527598) and int. registered design (M9001263) by WBT. WBT is a reg. trademark of WBT, Germany. \* Teflon is a reg. trademark of Du Pont.

All dimensions in mm, values in brackets: inch

## WBT-0274 Coaxial socket (RCA)

Coaxial socket for pc board mounting, *horizontal version*

- Mechanics**
  - single-segment, low-tolerance contact elements (tol. less than  $\pm 0.05$  mm)
  - base element with mounting posts machined directly from basic element
  - internal socket, exactly centered: WBT double prism contact with active spring principle due to a double-wrap bronze spring lock washer; large spring travel for constant contact pressure even if counterpieces are imprecisely worked
- Materials**
  - base element: "OFC" copper alloy (52% Cu)
  - internal socket: "OFC" copper (99.996% Cu)
  - dielectric: Teflon\*
  - external insulation: polyamide 6
- Surfaces**
  - base element: WBT 24-carat gold-plating  
Cu 1.5  $\mu$ m, Ni 8  $\mu$ m, Au 0.2  $\mu$ m
  - internal socket: WBT 24-carat gold-plating, 1 layer Au 0.3  $\mu$ m
- Operating characteristics** (reliably observed after more than  $10^3$  connections/disconnections)
  - constant current  $I_D > 40$  A
  - contact resistance  $R_C \leq 0.1$  mohms (loop, measured with WBT-0108)
  - volume resistance  $R_V \leq 0.05$  mohms
  - self-capacitance  $C \approx 6.3$  pF
  - insulation resistance  $R_{iso} > 10^{10}$  ohms
  - surge impedance (projective)  $Z = 16$  ohms
- Terminals**
  - soldering version for pc board mounting
  - direct solder contact and permanent fixing by self-securing cylinder head screw M2.5
- Mounting**
  - problem-free by hand using the knurled nut
  - for series processing we recommend the special mandrel tool WBT-0299
  - recommended distance of sockets center to center : 17.78 mm = 7/10 inch (standard)

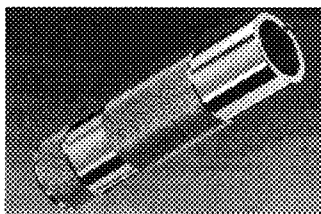
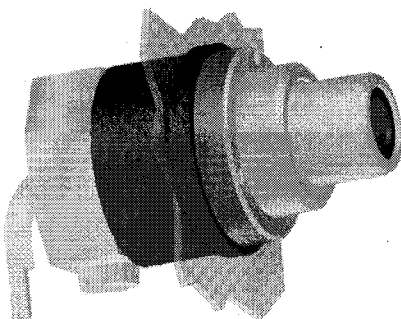

Special mandrel tool WBT-0299