

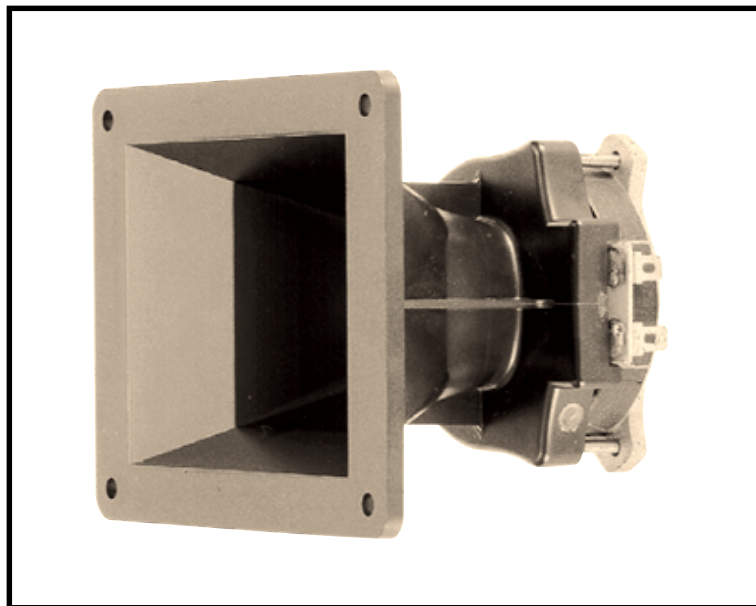

100HT

Features

- ◆ Horn Tweeter
- ◆ 8 ohm impedance
- ◆ 2kHz to 20kHz frequency response
- ◆ 102dB sensitivity at 1W/1m (3.3ft)
- ◆ 0.99kg (2.183 lb) net weight



Specifications

Impedance	: 8 ohm
Reproduction Frequency Response	: 2kHz - 20kHz
S.P.L.	: 102dB/W (m)
Continuous Rated Power	: 100W
Cutoff Frequency	: 2.5kHz
Recommended Cross-over Frequency	: more than 5kHz
Magnet Weight	: 100g (0.220 lb)
Net Weight	: 990g (2.183 lb)

Frequency Response / Impedance

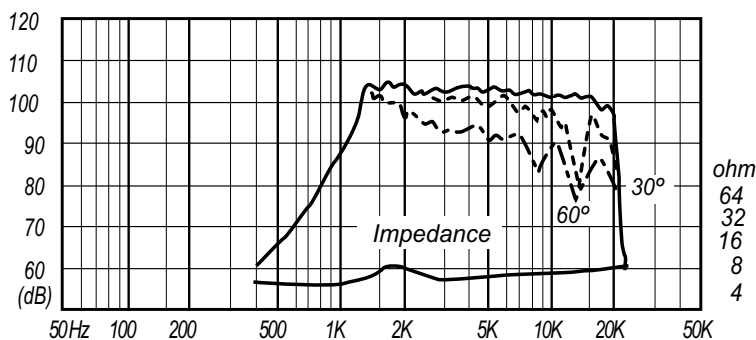

Dimensions & Mounting Information

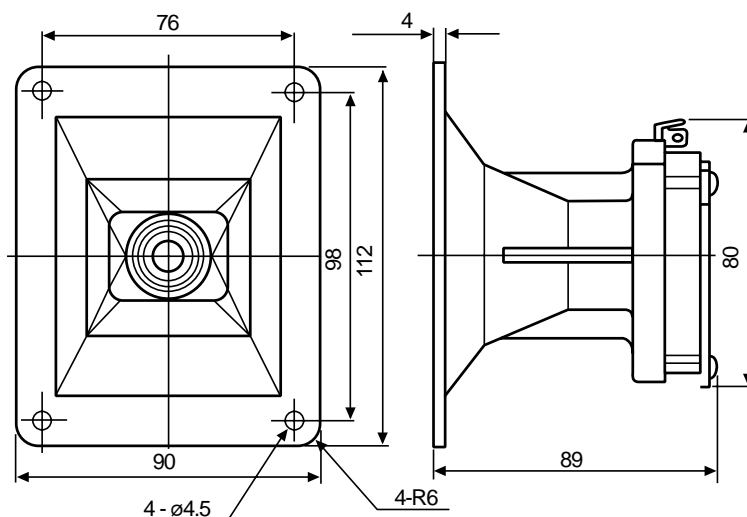



400HT

Features

- ◆ Horn Tweeter
- ◆ 8 ohm impedance
- ◆ 3kHz to 14kHz frequency response
- ◆ 108dB sensitivity at 1W/1m (3.3ft)
- ◆ 1.55kg (3.417 lb) net weight

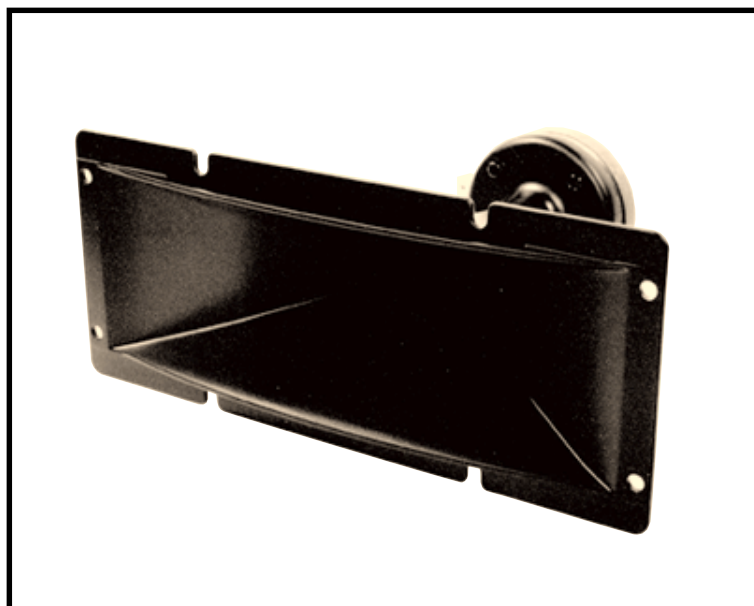

Specifications

Impedance	: 8 ohm
Reproduction Frequency Response	: 3kHz - 14kHz
S.P.L.	: 108dB/W (m)
Continuous Rated Power	: 120W
Cutoff Frequency	: 1.5kHz
Recommended Cross-over Frequency	: more than 3kHz (12dB/oct)
Magnet Weight	: 226g (0.498 lb)
Net Weight	: 1.55kg (3.417 lb)

Frequency Response / Impedance

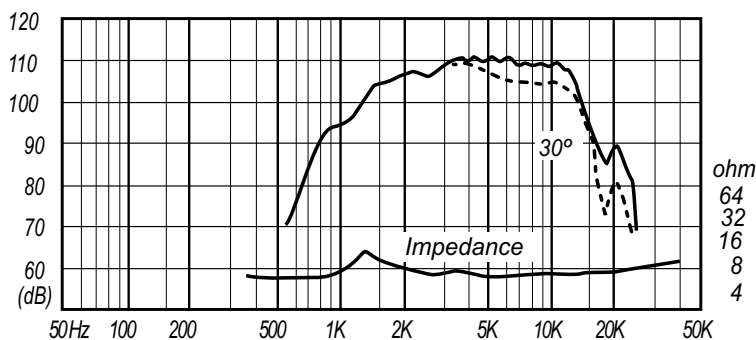

Dimensions & Mounting Information

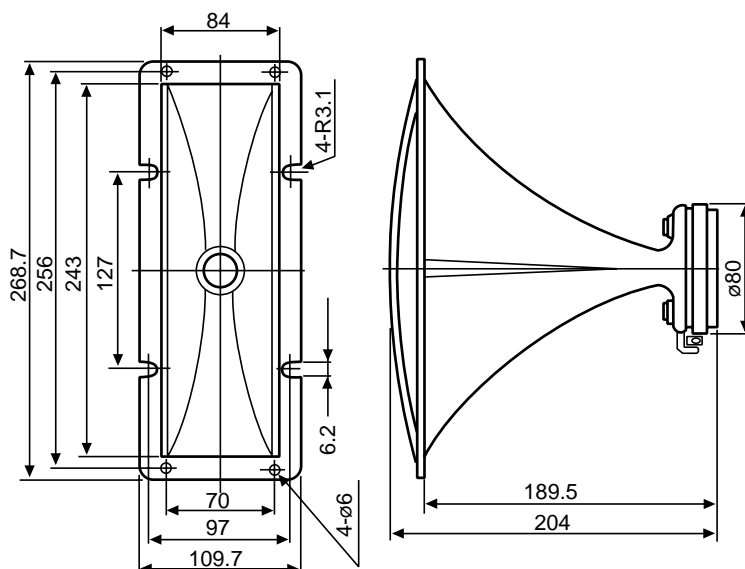



D1400

Features

- ◆ Horn Driver
- ◆ 8 ohm impedance
- ◆ 650Hz to 20kHz frequency response
- ◆ 104dB sensitivity at 1W/1m (3.3ft)
- ◆ 3.45kg (7.606 lb) net weight



Specifications

Throat Diameter	: 25.4mm (1 in)
Impedance	: 8 ohm
Reproduction Frequency Response	: 650Hz - 20kHz
S.P.L.	: 104dB/W (m)
Music Power	: 60W
Recommended Cross-over Frequency	: more than 750Hz
Magnet Weight	: 650g (1.433 lb)
Net Weight	: 3.45kg (7.606 lb)

Frequency Response / Impedance

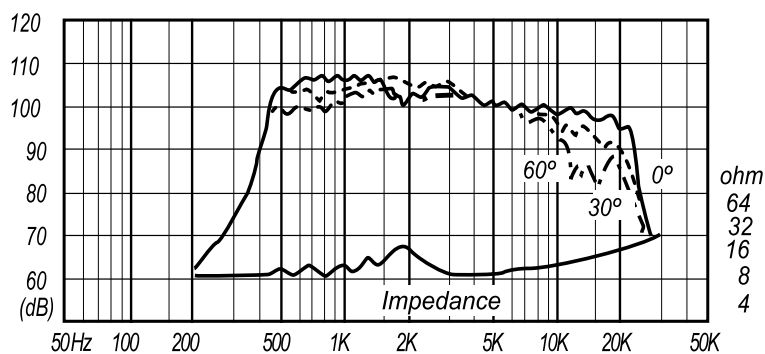

Configuration Example

W300A + D1400 + H300 + T500A

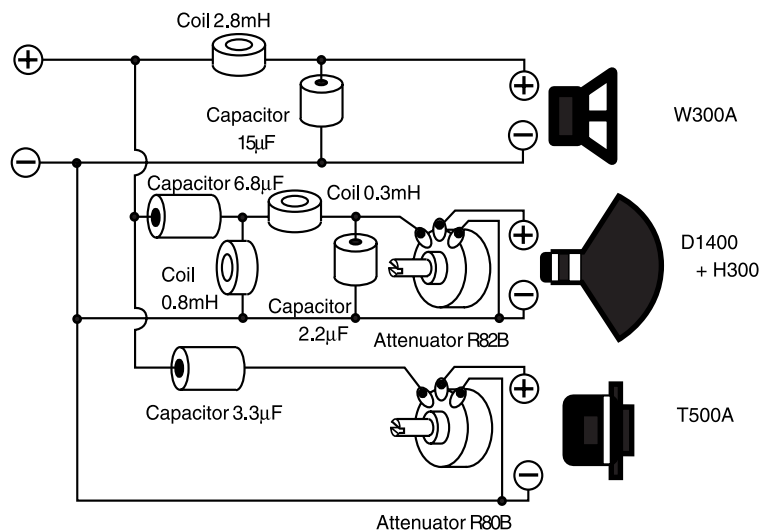



D1405

Features

- ◆ Horn Driver
- ◆ 8 ohm impedance
- ◆ 800Hz to 20kHz frequency response
- ◆ 104dB sensitivity at 1W/1m (3.3ft)
- ◆ 1.6kg (3.527 lb) net weight



Specifications

Throat Diameter	: 25.4mm (1 in)
Impedance	: 8 ohm
Reproduction Frequency Response	: 800Hz - 20kHz
S.P.L.	: 104dB/W (m)
Music Power	: 60W
Recommended Cross-over Frequency	: more than 850Hz
Magnet Weight	: 330g (0.728 lb)
Net Weight	: 1.6kg (3.527 lb)

Frequency Response / Impedance

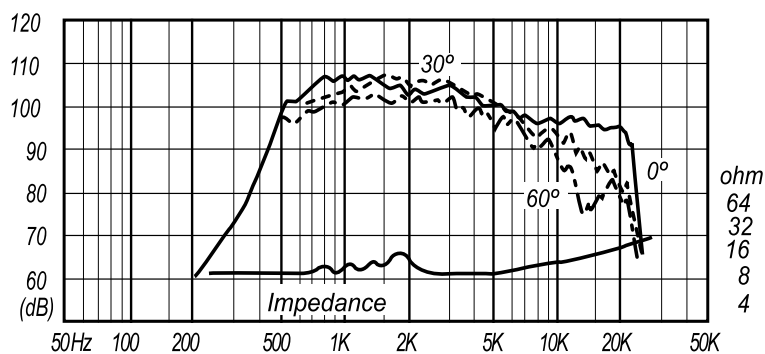

Configuration Example

W300A + D1405 + H400 + T925A

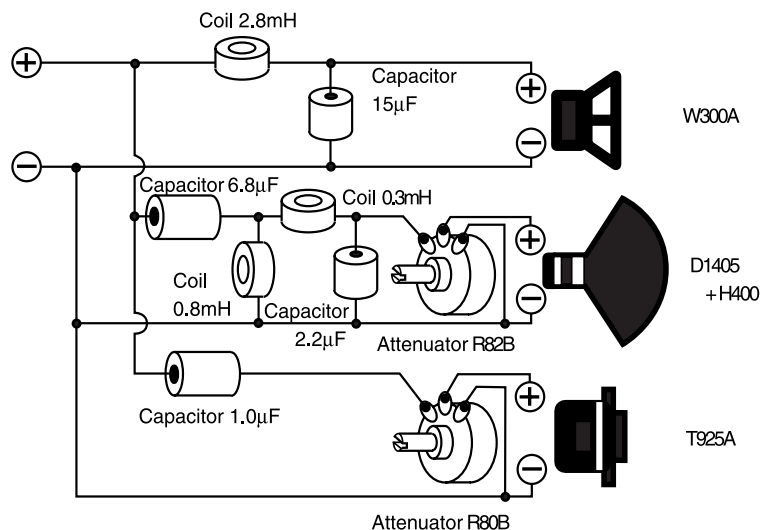



F-series

F120A

Features

- ◆ 120mm (5 in) cone type full range
- ◆ 8 ohm impedance
- ◆ fo to 20kHz frequency response
- ◆ 89dB sensitivity at 1W/1m (3.3ft)
- ◆ 2.0kg (4.409 lb) net weight



Specifications & Thiele/Small Parameters

Impedance	: 8 ohm
Minimum Frequency Response	: 65Hz
Reproduction Frequency Response	: fo - 20kHz
S.P.L.	: 89dB/W (m)
Rated Input	: 10W
Music Power	: 30W
Equivalent Diagram Radius	: 46mm (1.811 in)
Equivalent Mass	: 4.7g (0.010 lb)
Magnet Weight	: 211g (0.465 lb)
Net Weight	: 2.0kg (4.409 lb)
Fs	: 65Hz
Re	: 7.0 ohm
Qts	: 0.44
Qms	: 3.1
Qes	: 0.51
Vas	: 9.876 L
Xmax	: 1.5mm (0.059 in)
no	: 0.613%

Frequency Response / Impedance

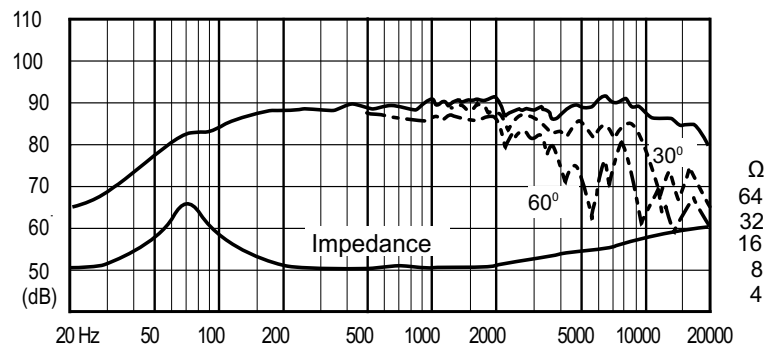

Dimensions & Mounting Information

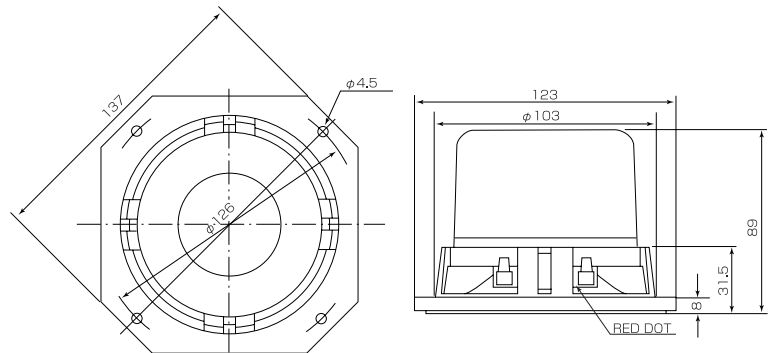



F-series

F200A

Features

- ◆ 200mm (8 in) cone type full range
- ◆ 8 ohm impedance
- ◆ fo to 20kHz frequency response
- ◆ 90dB sensitivity at 1W/1m (3.3ft)
- ◆ 4.4kg (9.700 lb) net weight



Specifications & Thiele/Small Parameters

Impedance	: 8 ohm
Minimum Frequency Response	: 30Hz
Reproduction Frequency Response	: fo - 20kHz
S.P.L.	: 90dB/W (m)
Rated Input	: 27W
Music Power	: 80W
Equivalent Diaphragm Radius	: 80mm (3.150 in)
Equivalent Mass	: 18.6g (0.041 lb)
Magnet Weight	: 907g (2.000 lb)
Net Weight	: 4.4kg (9.700 lb)
Fs	: 30Hz
Re	: 7.3 ohm
Qts	: 0.32
Qms	: 2.63
Qes	: 0.36
Vas	: 98.96 L
Xmax	: 2.0mm (0.079 in)
no	: 0.767%

Frequency Response / Impedance

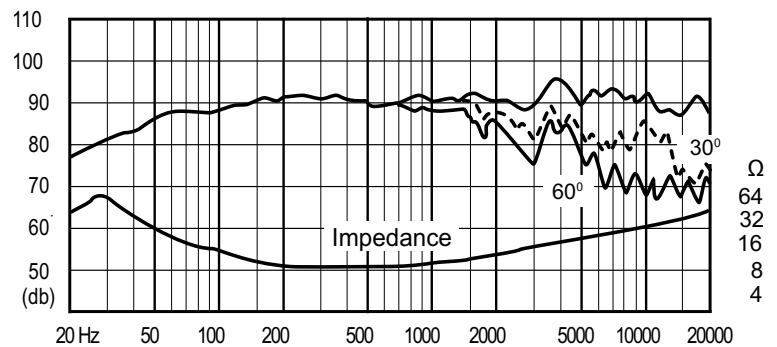

Dimensions & Mounting Information

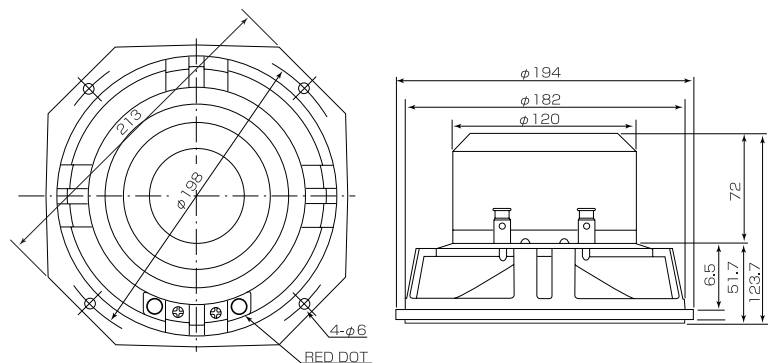

FE83E

Features

- 'ES cone' paper made of banana plant's fiber
- Newly designed center cap
- Ferrite magnet



Specifications & Thiele/Small Parameters

Size	:	80 mm / 3 in
Voice Coil Diameter	:	16 mm / 0.6 in
Cast / Stamped	:	Cast
Impedance	:	8 Ω
Reproduction Frequency Response	:	fs - 30 kHz
Sound Pressure Level	:	88 dB/W(m)
Rated Input	:	5 W
Music Power	:	10 W
Magnet Material	:	Ferrite
Magnet Weight	:	
(main)	:	140 g / 0.309 lb
(cancel)	:	g / lb
Net Weight	:	360 g / 0.794 lb

a	:	30 mm
D	:	60 mm
Sd	:	0.00283 m ²
Zn	:	8 Ω
Fs	:	127 Hz
Re	:	7.87 Ω
Le	:	n/a mH
Qms	:	4.00
Qes	:	0.98
Qts	:	0.79
Mms	:	1.39 g
BL	:	2.98 Telsa/m
Vas	:	1.29 L
Xmax	:	0.40 mm
Eff/η0	:	0.26 %
Cms	:	0.00115 mm/N
EBP	:	130

Frequency Response / Impedance

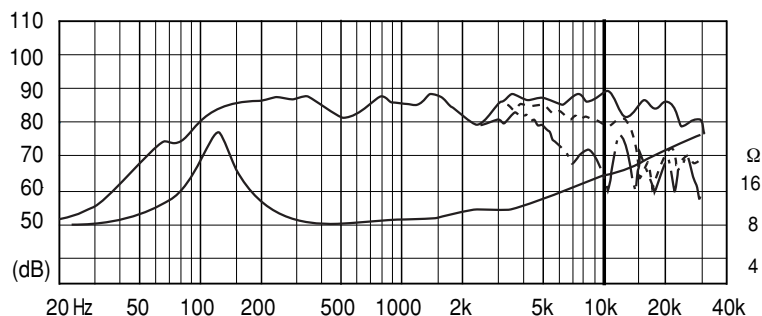

Dimensions & Mounting Information

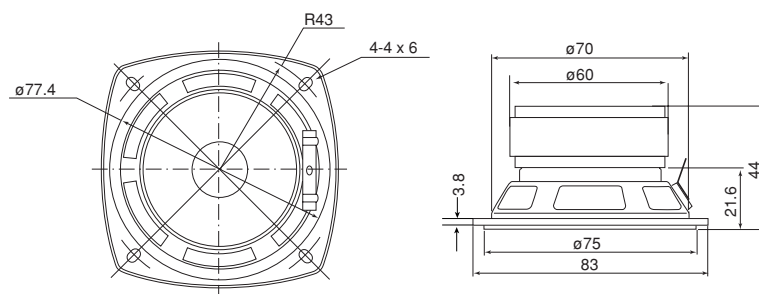

Overall Diameter	:	83 mm / 3.3 in
Baffle Hole Diameter	:	75 mm / 2.9 in
Depth	:	44 mm / 1.7 in

Fostex®

LOW LEAKAGE FLUX TYPE FULL RANGE
SPEAKER UNIT

FE87E

Features

- 'ES cone' paper made of banana plant's fiber
- Newly designed center cap
- Repulsion type magnetically shielded circuit
- Ferrite magnet

Specifications

&

Thiele/Small Parameters

Size	:	80 mm / 3 in
Voice Coil Diameter	:	16 mm / 0.6 in
Cast / Stamped	:	Stamped
Impedance	:	8 Ω
Reproduction Frequency Response	:	:fs - 30 kHz
Sound Pressure Level	:	89 dB/W(m)
Rated Input	:	5 W
Music Power	:	10 W
Magnet Material	:	Ferrite
Magnet Weight	:	
(main)	:	48.4 g / 0.107 lb
(cancel)	:	27.9 g / 0.062 lb
Net Weight	:	288 g / 0.635 lb

a	:	30 mm
D	:	60 mm
Sd	:	0.00283 m ²
Zn	:	8 Ω
Fs	:	140 Hz
Re	:	7.7 Ω
Le	:	n/a mH
Qms	:	3.77
Qes	:	1.20
Qts	:	0.92
Mms	:	1.4 g
BL	:	2.81 Telsa/m
Vas	:	1.03 L
Xmax	:	0.40 mm
Eff/η0	:	0.22 %
Cms	:	0.00092 mm/N
EBP	:	117



Frequency Response / Impedance

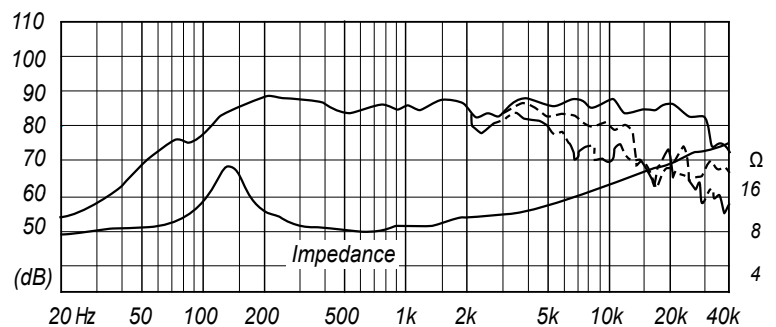

Dimensions & Mounting Information

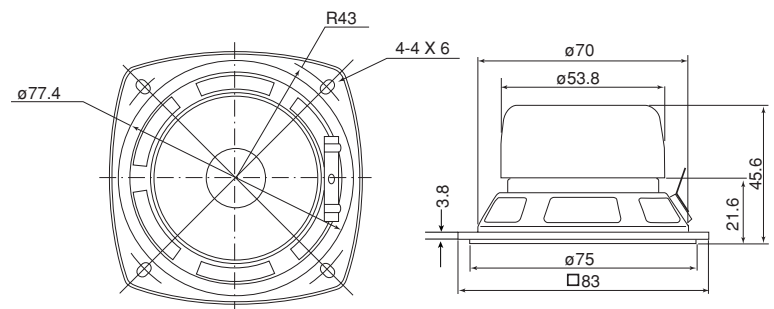

Overall Diameter	:	83 mm / 3.3 in
Baffle Hole Diameter	:	75 mm / 2.9 in
Depth	:	45.6 mm / 1.8 in

FE103E

Features

- 'ES cone' paper made of banana plant's fiber
- Newly designed center cap
- Ferrite magnet



Specifications

&

Thiele/Small Parameters

Size	:	100 mm / 4 in
Voice Coil Diameter	:	20 mm / 0.8 in
Cast / Stamped	:	Stamped
Impedance	:	8 Ω
Reproduction Frequency Response	:	fs - 22 kHz
Sound Pressure Level	:	89 dB/W(m)
Rated Input	:	5 W
Music Power	:	15 W
Magnet Material	:	Ferrite
Magnet Weight	:	
(main)	:	193 g / 0.425 lb
(cancel)	:	g / lb
Net Weight	:	630 g / 1.389 lb

a	:	40 mm
D	:	80 mm
Sd	:	0.00503 m ²
Zn	:	8 Ω
Fs	:	79.5 Hz
Re	:	7.45 Ω
Le	:	n/a mH
Qms	:	2.87
Qes	:	0.40
Qts	:	0.36
Mms	:	2.10 g
BL	:	4.42 Telsa/m
Vas	:	6.90 L
Xmax	:	0.35 mm
Eff/η0	:	0.83 %
Cms	:	0.00194 mm/N
EBP	:	199

Frequency Response / Impedance

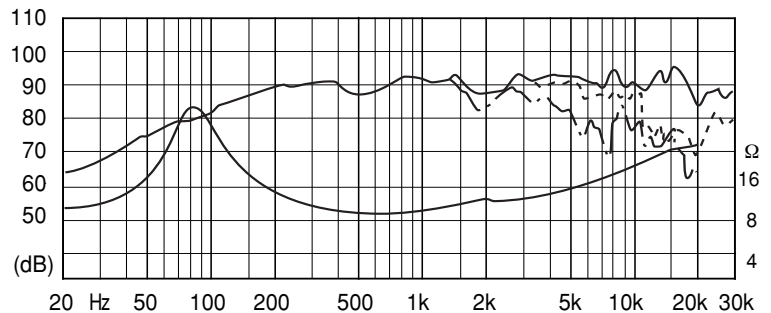

Dimensions & Mounting Information

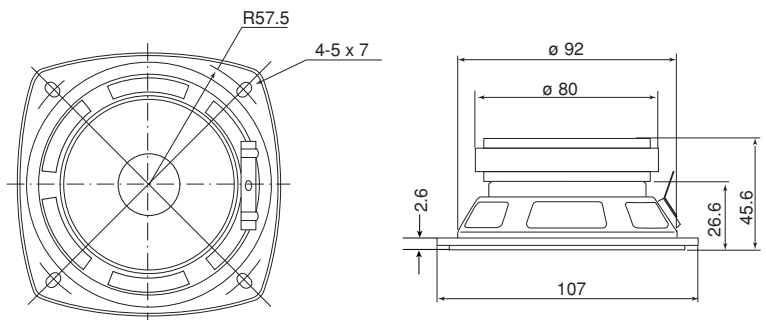

Overall Diameter	:	107 mm / 4.2 in
Baffle Hole Diameter	:	92 mm / 3.6 in
Depth	:	45.6 mm / 1.8 in

Fostex®

LOW LEAKAGE FLUX TYPE FULL RANGE
SPEAKER UNIT

FE107E

Features

- 'ES cone' paper made of banana plant's fiber
- Newly designed center cap
- Repulsion type magnetically shielded circuit
- Ferrite magnet

Specifications

&

Thiele/Small Parameters

Size	:	100 mm / 4 in
Voice Coil Diameter	:	20 mm / 0.8 in
Cast / Stamped	:	Stamped
Impedance	:	8 Ω
Reproduction Frequency Response	:	fs - 22 kHz
Sound Pressure Level	:	90 dB/W(m)
Rated Input	:	5 W
Music Power	:	15 W
Magnet Material	:	Ferrite
Magnet Weight	:	
(main)	:	101 g / 0.223 lb
(cancel)	:	59 g / 0.130 lb
Net Weight	:	550 g / 1.213 lb

a	:	40 mm
D	:	80 mm
Sd	:	0.00503 m ²
Zn	:	8 Ω
Fs	:	80 Hz
Re	:	7.60 Ω
Le	:	n/a mH
Qms	:	2.56
Qes	:	0.45
Qts	:	0.38
Mms	:	2.6 g
BL	:	4.7 Telsa/m
Vas	:	5.95 L
Xmax	:	0.35 mm
Eff/η0	:	0.35 %
Cms	:	0.00168 mm/N
EBP	:	178



Frequency Response / Impedance

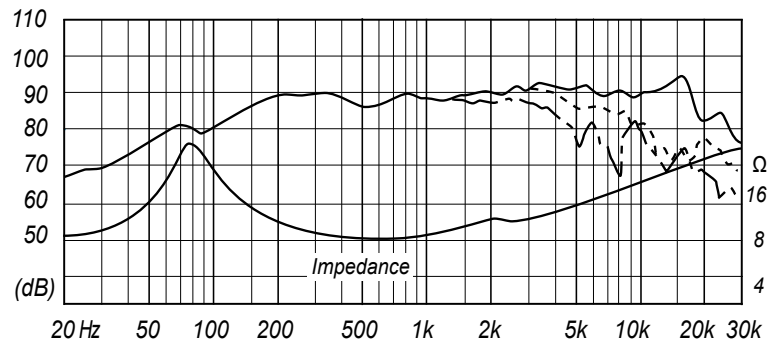

Dimensions & Mounting Information

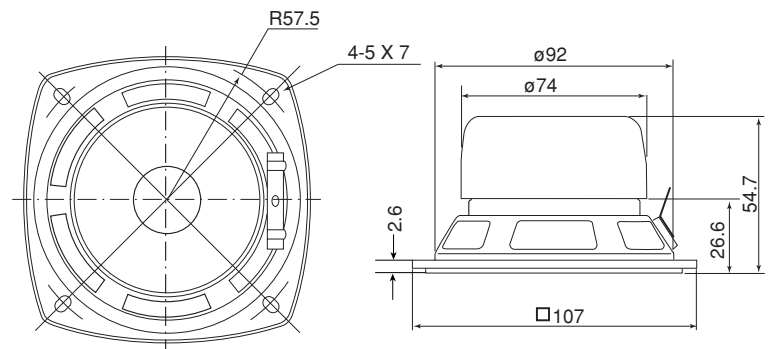

Overall Diameter	:	107 mm / 4.2 in
Baffle Hole Diameter	:	107 mm / 4.2 in
	:	92 mm / 3.6 in
Depth	:	54.7 mm / 2.2 in

Fostex®

FULL RANGE SPEAKER UNIT

FE108EΣ

Features

- HP (Hyperbolic Paraboloid) shell diaphragm
- 'ES cone' paper made of banana plant's fiber
- UDR tangential edge / damper
- ø 90mm large ferrite magnet

Specifications

&

Thiele/Small Parameters

Size	:	100 mm / 4 in
Voice Coil Diameter	:	20 mm / 0.8 in
Cast / Stamped	:	Cast
Impedance	:	8 Ω
Reproduction Frequency Response	:	fs - 23 kHz
Sound Pressure Level	:	90 dB/W(m)
Rated Input	:	8 W
Music Power	:	24 W
Magnet Material	:	Ferrite
Magnet Weight	:	
(main)	:	400 g / 0.882 lb
(cancel)	:	g / lb
Net Weight	:	1,200 g / 2.646 lb

a	:	40 mm
D	:	69.2 mm
Sd	:	0.005 m ²
Zn	:	8 Ω
Fs	:	77 Hz
Re	:	6.8 Ω
Le	:	0.038 mH
Qms	:	7.79
Qes	:	0.32
Qts	:	0.3
Mms	:	2.7 g
BL	:	5.2 Telsa/m
Vas	:	5.7 L
Xmax	:	0.28 mm
Eff/η0	:	0.78 %
Cms	:	1.59 mm/N
EBP	:	240.63



Frequency Response / Impedance

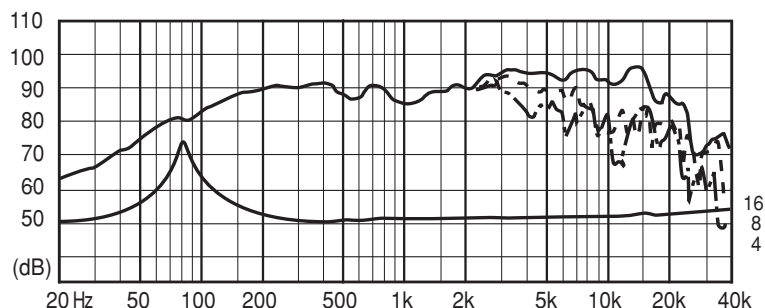

Dimensions & Mounting Information

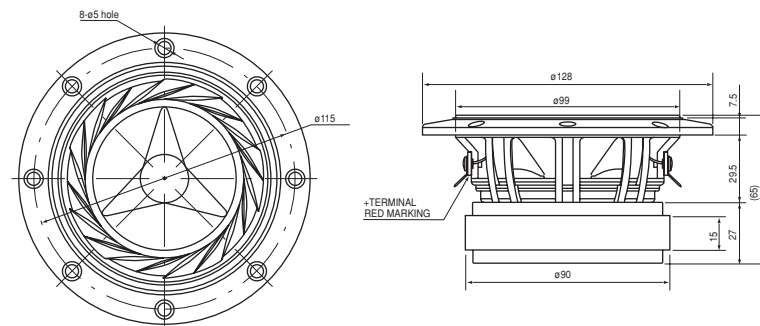

Overall Diameter	:	128 mm / 5.1 in
Baffle Hole Diameter	:	99 mm / 3.9 in
Depth	:	102 mm / 4.1 in
	:	65 mm / 2.6 in

Fostex®

LOW LEAKAGE FLUX TYPE FULL RANGE
SPEAKER UNIT

FE127E

Features

- 'ES cone' paper made of banana plant's fiber
- Newly designed center cap
- Repulsion type magnetically shielded circuit
- Ferrite magnet

Specifications

&

Thiele/Small Parameters

Size	:	120 mm / 4.7 in
Voice Coil Diameter	:	20 mm / 0.8 in
Cast / Stamped	:	Stamped
Impedance	:	8 Ω
Reproduction Frequency Response	:	fs - 20 kHz
Sound Pressure Level	:	91 dB/W(m)
Rated Input	:	15 W
Music Power	:	45 W
Magnet Material	:	Ferrite
Magnet Weight	:	
(main)	:	100 g / 0.220 lb
(cancel)	:	59 g / 0.130 lb
Net Weight	:	574 g / 1.265 lb

a	:	46 mm
D	:	92 mm
Sd	:	0.00665 m ²
Zn	:	8 Ω
Fs	:	70.4 Hz
Re	:	6.50 Ω
Le	:	n/a mH
Qms	:	3.33
Qes	:	0.50
Qts	:	0.43
Mms	:	2.98 g
BL	:	4.14 Telsa/m
Vas	:	9.9 L
Xmax	:	0.67 mm
Eff/η0	:	0.35 %
Cms	:	0.0016 mm/N
EBP	:	141



Frequency Response / Impedance

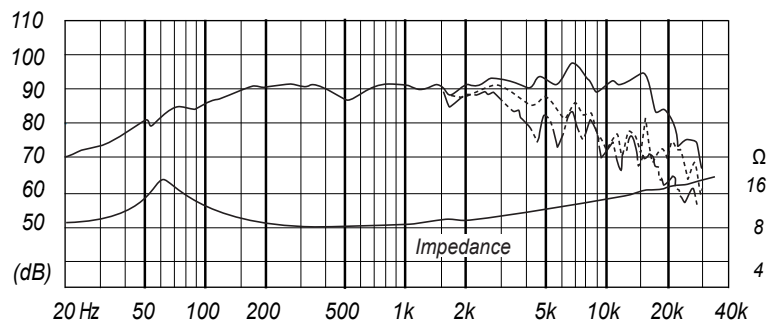

Dimensions & Mounting Information

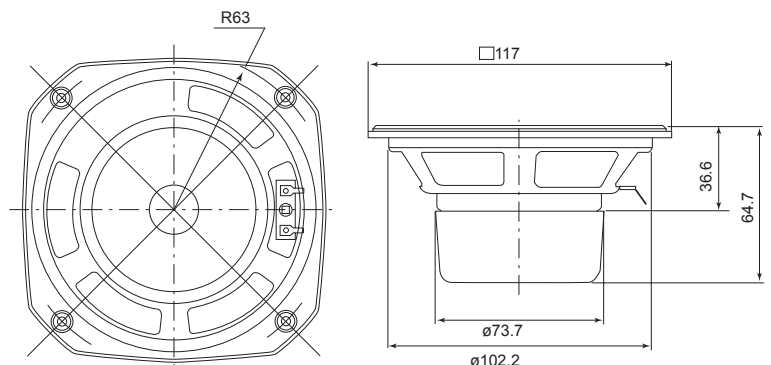

Overall Diameter	:	117 mm / 4.6 in
Baffle Hole Diameter	:	102.2 mm / 4.0 in
Depth	:	64.7 mm / 2.5 in

Fostex®

FULL RANGE SPEAKER UNIT

FE166E

Features

- 'ES cone' paper made of banana plant's fiber
- ø 110mm large ferrite magnet
- Newly designed center cap



Specifications & Thiele/Small Parameters

Size	:	160 mm / 6 in
Voice Coil Diameter	:	25 mm / 1 in
Cast / Stamped	:	Stamped
Impedance	:	8 Ω
Reproduction Frequency Response	:	f0 - 22 kHz
Sound Pressure Level	:	94 dB/W(m)
Rated Input	:	22 W
Music Power	:	65 W
Magnet Material	:	Ferrite
Magnet Weight	:	
(main)	:	600.0 g / 1.323 lb
(cancel)	:	n/a g / n/a lb
Net Weight	:	1,600 g / 3,527 lb

Frequency Response / Impedance

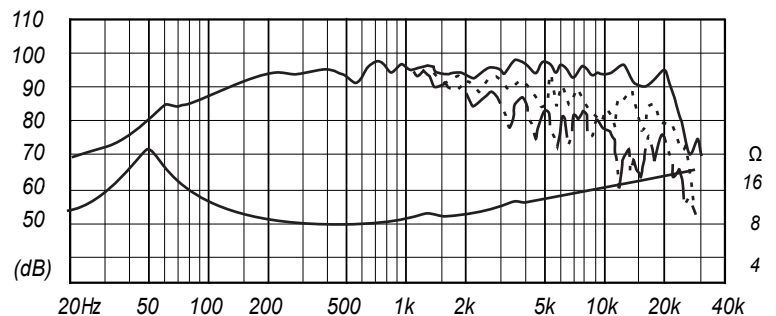

Dimensions & Mounting Information

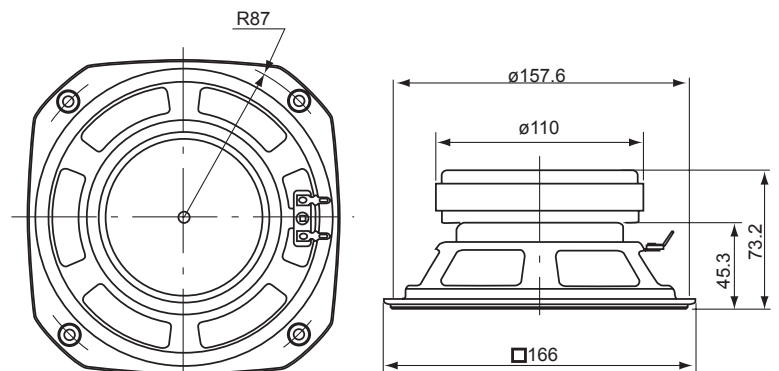

a :	65 mm
D :	130 mm
Sd :	0.01327 m ²
Zn :	8 Ω
Fs :	50 Hz
Re :	7.10 Ω
Le :	n/a mH
Qms :	3.89
Qes :	0.22
Qts :	0.21
Mms :	6.85 g
BL :	8.33 Telsa/m
Vas :	45.11 L
Xmax :	0.6 mm
Eff/η0 :	1.83 %
Cms :	0.00182 mm/N
EBP :	227

Overall Diameter	:	166 mm / 7 in
Baffle Hole Diameter	:	110 mm / 4.3 in
Depth	:	73.2 mm / 3 in

Fostex®

LOW LEAKAGE FLUX TYPE FULL RANGE SPEAKER UNIT

FE167E

Features

- 'ES cone' paper made of banana plant's fiber
- Ferrite magnet
- Repulsion type magnetically shielded circuit
- Newly designed center cap

Specifications

&

Thiele/Small Parameters

Size	:	160 mm / 6 in
Voice Coil Diameter	:	25 mm / 1 in
Cast / Stamped	:	Stamped
Impedance	:	8 Ω
Reproduction Frequency Response	:	f0 - 22 kHz
Sound Pressure Level	:	94 dB/W(m)
Rated Input	:	22 W
Music Power	:	65 W
Magnet Material	:	Ferrite
Magnet Weight	:	
(main)	:	240.1 g / 0.529 lb
(cancel)	:	121.8 g / 0.269 lb
Net Weight	:	1,320 g / 2.910 lb



Frequency Response / Impedance

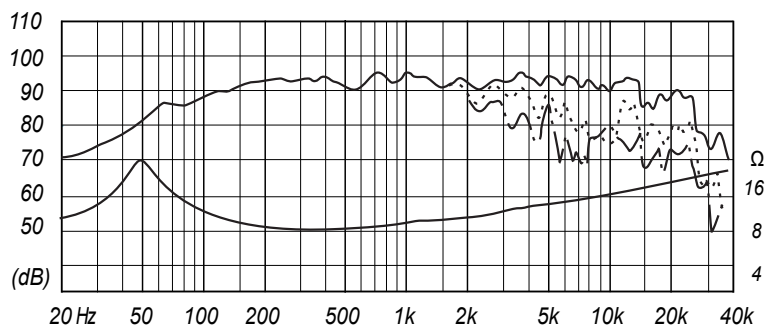

Dimensions & Mounting Information

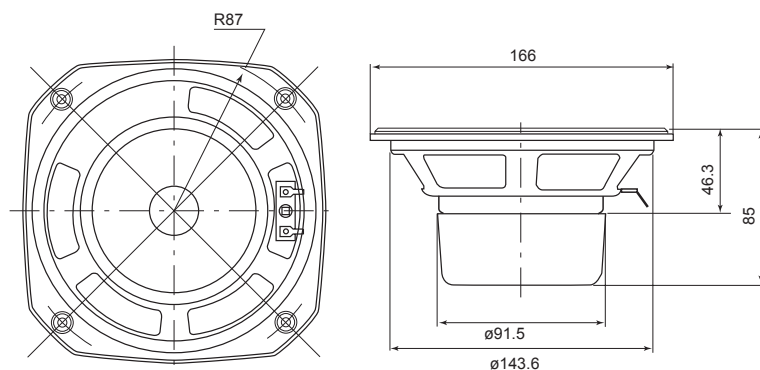

a :	65 mm
D :	130 mm
Sd :	0.01327 m ²
Zn :	8 Ω
Fs :	51.5 Hz
Re :	7.10 Ω
Le :	n/a mH
Qms :	4.63
Qes :	0.33
Qts :	0.31
Mms :	6.68 g
BL :	6.82 Telsa/m
Vas :	35.94 L
Xmax :	0.6 mm
Eff/η0 :	1.44 %
Cms :	0.00145 mm/N
EBP :	156

Overall Diameter	:	166 mm / 7 in
Baffle Hole Diameter	:	146 mm / 6 in
Depth	:	85 mm / 3 in

Fostex®

FULL RANGE SPEAKER UNIT

FE168EΣ

Features

- HP (Hyperbolic Paraboloid) shell diaphragm
- 'ES cone' paper made of banana plant's fiber
- UDR tangential edge / damper
- ø 120mm large ferrite magnet



Specifications

&

Thiele/Small Parameters

Size	:	160 mm / 6.5 in
Voice Coil Diameter	:	30 mm / 1.2 in
Cast / Stamped	:	Cast
Impedance	:	8 Ω
Reproduction Frequency Response	:	fs - 21 kHz
Sound Pressure Level	:	94.5 dB/W(m)
Rated Input	:	27 W
Music Power	:	80 W
Magnet Material	:	Ferrite
Magnet Weight	:	
(main)	:	721 g / 1.590 lb
(cancel)	:	g / lb
Net Weight	:	2,600 g / 5.732 lb

Frequency Response / Impedance

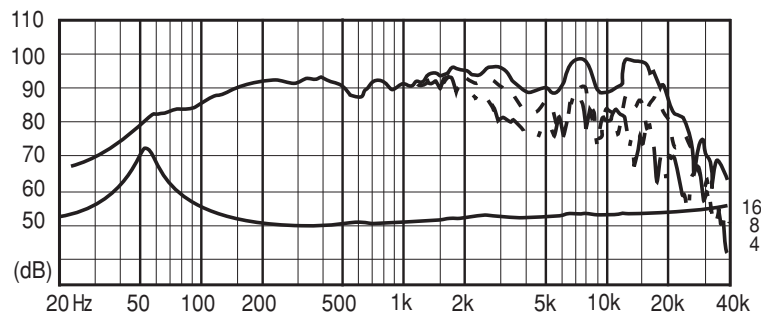

a	:	60 mm
D	:	106 mm
Sd	:	0.0113 m ²
Zn	:	8 Ω
Fs	:	51 Hz
Re	:	6.8 Ω
Le	:	0.056 mH
Qms	:	5.328
Qes	:	0.27
Qts	:	0.26
Mms	:	8.7 g
BL	:	8 Telsa/m
Vas	:	23.7 L
Xmax	:	1.6 mm
Eff/η0	:	0.9 %
Cms	:	1.278 mm/N
EBP	:	188.89

Dimensions & Mounting Information

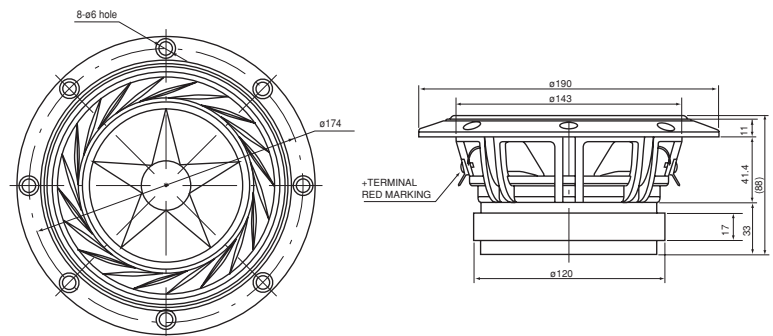

Overall Diameter	:	190 mm / 7.5 in
Baffle Hole Diameter	:	155 mm / 6.2 in
Depth	:	88 mm / 4.0 in

Fostex®

FULL RANGE SPEAKER UNIT

FE206E

Features

- 'ES cone' paper made of banana plant's fiber
- \varnothing 110mm large ferrite magnet
- Newly designed center cap



Specifications

&

Thiele/Small Parameters

Size	:	200 mm / 8 in
Voice Coil Diameter	:	35 mm / 1.4 in
Cast / Stamped	:	Stamped
Impedance	:	8 Ω
Reproduction Frequency Response	:	f ₀ - 20 kHz
Sound Pressure Level	:	96 dB/W(m)
Rated Input	:	30 W
Music Power	:	90 W
Magnet Material	:	Ferrite
Magnet Weight	:	
(main)	:	1,067 g / 2.352 lb
(cancel)	:	n/a g / n/a lb
Net Weight	:	3,350 g / 7.385 lb

Frequency Response / Impedance

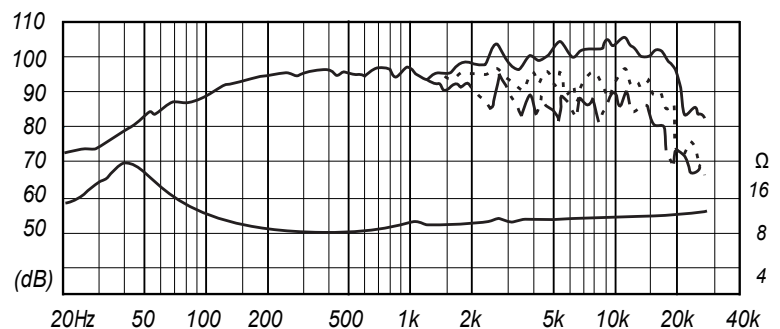

Dimensions & Mounting Information

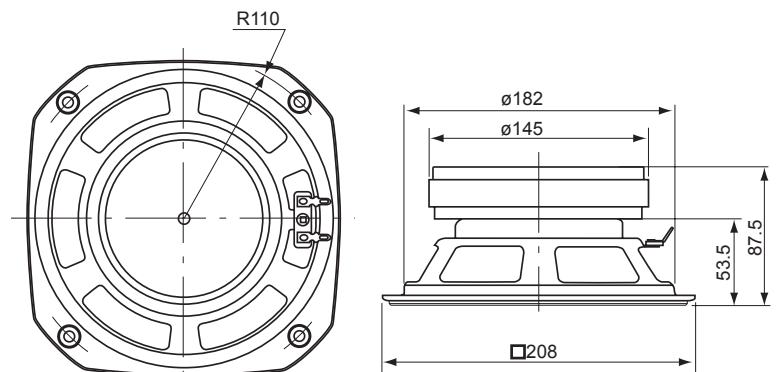

a	:	81 mm
D	:	162 mm
S _d	:	0.02061 m ²
Z _n	:	8 Ω
F _s	:	39 Hz
Re	:	6.69 Ω
Le	:	n/amH
Q _{ms}	:	3.73
Q _{es}	:	0.18
Q _{ts}	:	0.18
M _{ms}	:	15.35 g
BL	:	11.82 Telsa/m
V _{as}	:	54.53 L
X _{max}	:	1.5 mm
Eff/ η ₀	:	1.73 %
C _{ms}	:	0.00091 mm/N
EBP	:	217

Overall Diameter	:	208 mm / 8 in
Baffle Hole Diameter	:	145 mm / 5.7 in
Depth	:	87.5 mm / 3 in



LOW LEAKAGE FLUX TYPE FULL RANGE
SPEAKER UNIT

FE207E

Features

- 'ES cone' paper made of banana plant's fiber
- Ferrite magnet
- Repulsion type magnetically shielded circuit
- Newly designed center cap



Specifications

&

Thiele/Small Parameters

Size	:	200 mm / 8 in
Voice Coil Diameter	:	35 mm / 1.4 in
Cast / Stamped	:	Stamped
Impedance	:	8 Ω
Reproduction Frequency Response	:	f0 - 20 kHz
Sound Pressure Level	:	95 dB/W(m)
Rated Input	:	30 W
Music Power	:	90 W
Magnet Material	:	Ferrite
Magnet Weight	:	
(main)	:	337.0 g / 0.743 lb
(cancel)	:	329.9 g / 0.727 lb
Net Weight	:	2,650 g / 5.842 lb

Frequency Response / Impedance

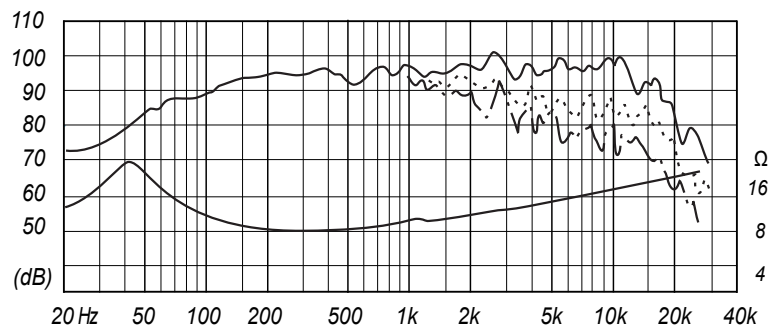

Dimensions & Mounting Information

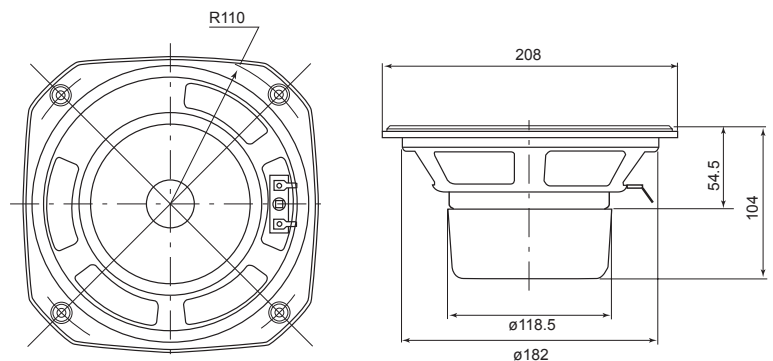

a	:	81 mm
D	:	162 mm
Sd	:	0.02061 m ²
Zn	:	8 Ω
Fs	:	39 Hz
Re	:	6.73 Ω
Le	:	n/amH
Qms	:	3.86
Qes	:	0.28
Qts	:	0.26
Mms	:	15.02 g
BL	:	9.41 Telsa/m
Vas	:	56.25 L
Xmax	:	1.5 mm
Eff/η0	:	1.17 %
Cms	:	0.00094 mm/N
EBP	:	139

Overall Diameter	:	208 mm / 8 in
Baffle Hole Diameter	:	118.5 mm / 4.67 in
Depth	:	104 mm / 4 in



FULL RANGE SPEAKER UNIT

FE208EΣ

Features

- HP (Hyperbolic Paraboloid) shell diaphragm
- 'ES cone' paper made of banana plant's fiber
- UDR tangential edge / damper
- \varnothing 156mm large ferrite magnet



Specifications

&

Thiele/Small Parameters

Size	:	200 mm / 8 in
Voice Coil Diameter	:	35 mm / 1.3 in
Cast / Stamped	:	Cast
Impedance	:	8 Ω
Reproduction Frequency Response	:	fs - 14 kHz
Sound Pressure Level	:	97 dB/W(m)
Rated Input	:	40 W
Music Power	:	120W
Magnet Material	:	Ferrite
Magnet Weight	:	
(main)	:	1,408.7 g / 3.106 lb
(cancel)	:	n/a g / n/a lb
Net Weight	:	4,800 g / 10.58 lb

Frequency Response / Impedance

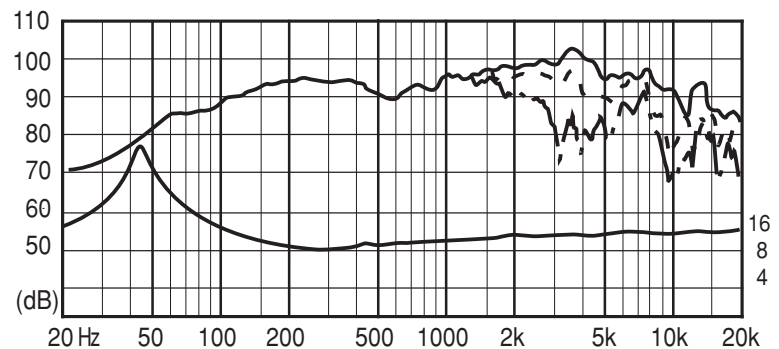

Dimensions & Mounting Information

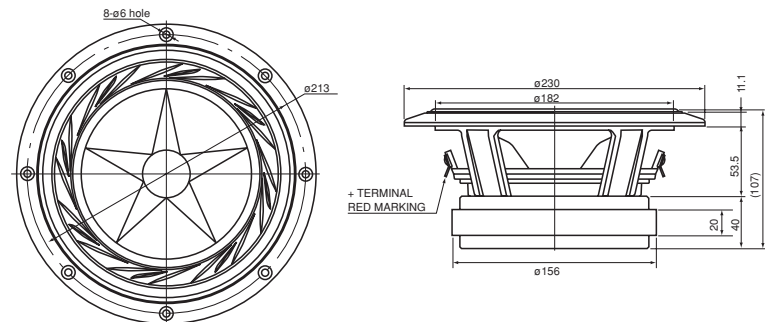

a :	80 mm
D :	144 mm
Sd :	0.0201 m ²
Zn :	8 Ω
Fs :	42 Hz
Re :	6.4 Ω
Le :	0.0517 mH
Qms :	6.191
Qes :	0.19
Qts :	0.18
Mms :	13.3 g
BL :	10.8 Telsa/m
Vas :	60.1 L
Xmax :	1.25 mm
Eff/η0 :	2.278 %
Cms :	1.069 mm/N
EBP :	221.05

Overall Diameter	:	230 mm / 9 in
Baffle Hole Diameter	:	185 mm / 7 in
Depth	:	93.5 mm / 4 in

Fostex®

FULL RANGE SPEAKER UNIT

FF85K

Features

- $\varnothing 70\text{mm}$ large ferrite magnet
- Special paper cone made of 'non-wood pulp fiber [KENAF] and bio-cellulose fiber
- UDR tangential edge
- Aluminum center radiator connected onto voice coil

Specifications

&

Thiele/Small Parameters

Size	:	80 mm / 3 in
Voice Coil Diameter	:	20 mm / 1 in
Cast / Stamped	:	Stamped
Impedance	:	8 Ω
Reproduction Frequency Response	:	f ₀ - 125kHz
Sound Pressure Level	:	88 dB/W(m)
Rated Input	:	5
Music Power	:	10 W
Magnet Material	:	Ferrite
Magnet Weight	:	
(main)	:	228.3 g / 0.503 lb
(cancel)	:	n/a g / n/a lb
Net Weight	:	565.0 g / 1.246 lb



Frequency Response / Impedance

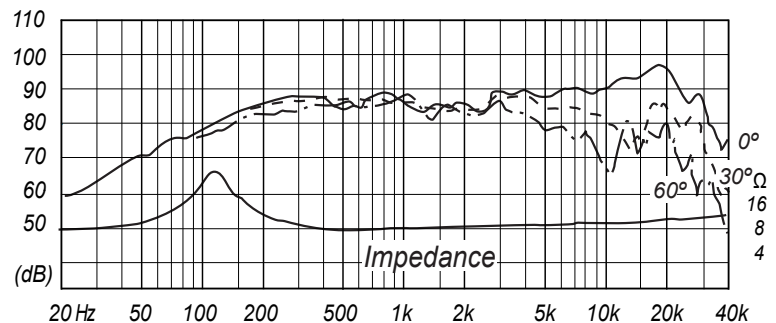

Dimensions & Mounting Information

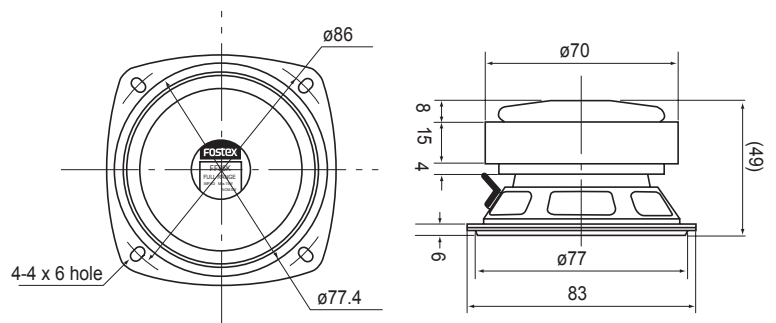

a :	3 mm
D :	6 mm
S _d :	0.00283 m ²
Z _n :	8 Ω
F _s :	122 Hz
Re :	7.08 Ω
Le :	n/amH
Q _{ms} :	5.54
Q _{es} :	0.52
Q _{ts} :	0.47
M _{ms} :	1.8 g
BL :	4.33 Telsa/m
V _{as} :	1.07 L
X _{max} :	0.55 mm
Eff/ η ₀ :	0.37 %
C _{ms} :	0.001 mm/N
EBP :	235

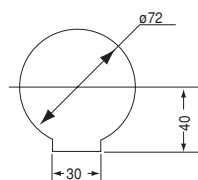

Overall Diameter	:	83 mm / 3 in
Baffle Hole Diameter	:	77 mm / 3 in
Depth	:	49 mm / 2 in



FF-series

FF125K

Features

- ◆ 120mm (4.5 in) cone type full range
- ◆ 8 ohm impedance
- ◆ fo to 18kHz frequency response
- ◆ 92dB sensitivity at 1W/1m (3.3ft)
- ◆ 0.93kg (2.05 lb) net weight



Specifications & Thiele/Small Parameters

Impedance	: 8 ohm
Minimum Frequency Response	: 70Hz
Reproduction Frequency Response	: fo - 18kHz
S.P.L.	: 92dB/W (m)
Rated Input	: 16W
Music Power	: 50W
Equivalent Diaphragm Radius	: 46mm (1.81 in)
Equivalent Mass	: 4.0g (0.088 lb)
Magnet Weight	: 420.0g (0.93 lb)
Net Weight	: 0.93kg (2.05 lb)
Fs	: 72Hz
Re	: 7.2 ohm
Qts	: 0.26
Qms	: 9.04
Qes	: 0.27
Vas	: 9.12 L
Xmax	: 0.15mm (0.005 in)
no	: 0.89%

Frequency Response / Impedance

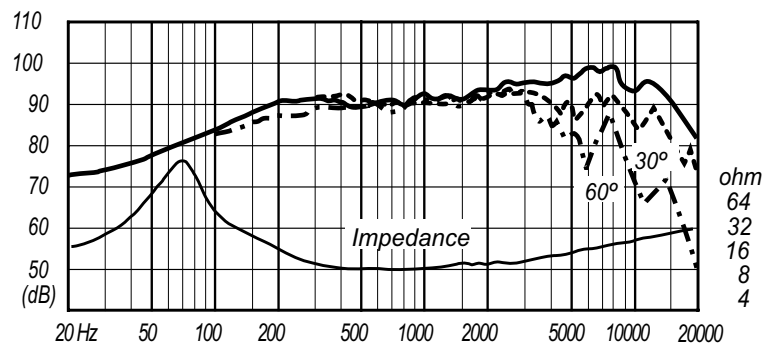

Dimensions & Mounting Information

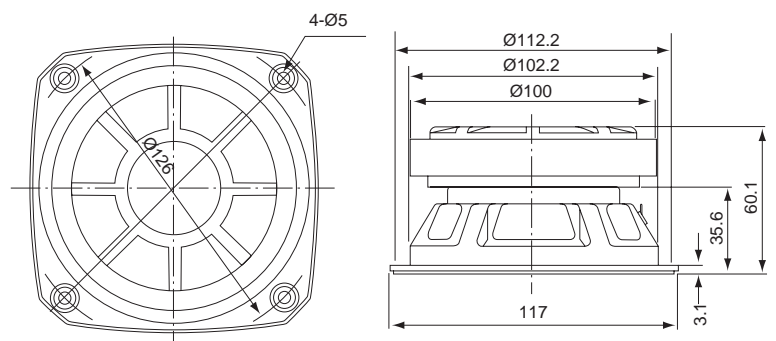



FF-series

FF165K

Features

- ◆ 160mm (6.5 in) cone type full range
- ◆ 8 ohm impedance
- ◆ fo to 17kHz frequency response
- ◆ 94dB sensitivity at 1W/1m (3.3ft)
- ◆ 1.6kg (3.53 lb) net weight



Specifications & Thiele/Small Parameters

Impedance	: 8 ohm
Minimum Frequency Response	: 40Hz
Reproduction Frequency Response	: fo - 17kHz
S.P.L.	: 94dB/W (m)
Rated Input	: 22W
Music Power	: 70W
Equivalent Diagram Radius	: 65mm (2.56 in)
Equivalent Mass	: 7.8g (0.172 lb)
Magnet Weight	: 600.0g (1.32 lb)
Net Weight	: 1.6kg (3.53 lb)
Fs	: 40Hz
Re	: 7.4 ohm
Qts	: 0.20
Qms	: 10.92
Qes	: 0.21
Vas	: 48.2 L
Xmax	: 0.3mm (0.001 in)
no	: 1.461%

Frequency Response / Impedance

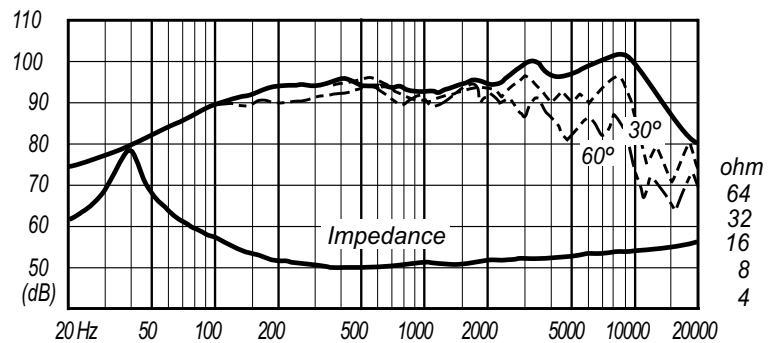

Dimensions & Mounting Information

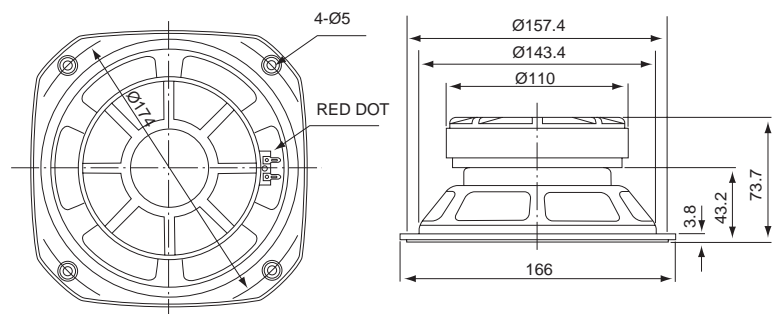



FF-series

FF125K

Features

- ◆ 120mm (4.5 in) cone type full range
- ◆ 8 ohm impedance
- ◆ fo to 18kHz frequency response
- ◆ 92dB sensitivity at 1W/1m (3.3ft)
- ◆ 0.93kg (2.05 lb) net weight



Specifications & Thiele/Small Parameters

Impedance	: 8 ohm
Minimum Frequency Response	: 70Hz
Reproduction Frequency Response	: fo - 18kHz
S.P.L.	: 92dB/W (m)
Rated Input	: 16W
Music Power	: 50W
Equivalent Diaphragm Radius	: 46mm (1.81 in)
Equivalent Mass	: 4.0g (0.088 lb)
Magnet Weight	: 420.0g (0.93 lb)
Net Weight	: 0.93kg (2.05 lb)
Fs	: 72Hz
Re	: 7.2 ohm
Qts	: 0.26
Qms	: 9.04
Qes	: 0.27
Vas	: 9.12 L
Xmax	: 0.15mm (0.005 in)
no	: 0.89%

Frequency Response / Impedance

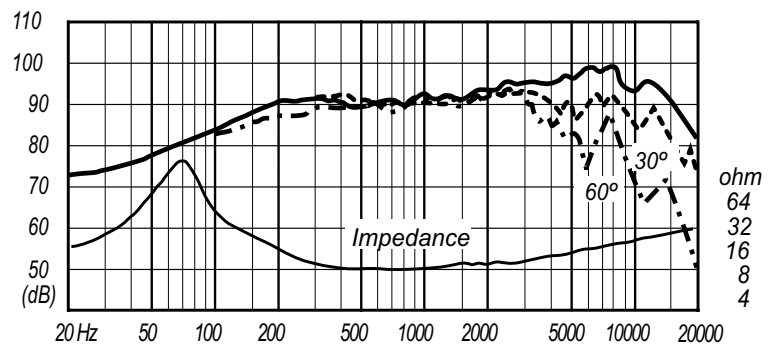

Dimensions & Mounting Information

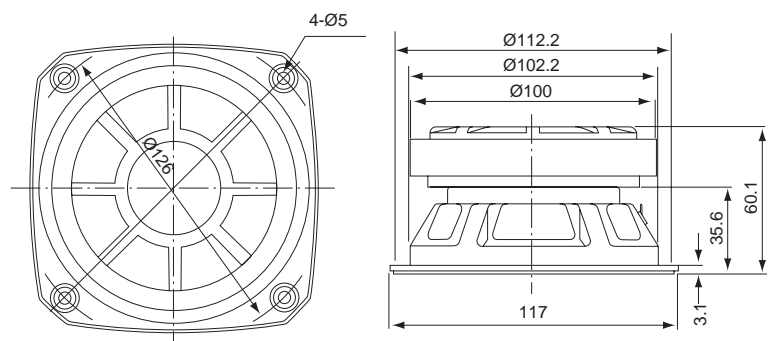



FT7RP

Features

- ◆ RP Tweeter
- ◆ 8 ohm impedance
- ◆ 3kHz to 45kHz frequency response
- ◆ 93dB sensitivity at 1W/1m (3.3ft)
- ◆ 0.155kg (0.34 lb) net weight



Specifications

Impedance	: 8 ohm
Reproduction Frequency Response	: 3kHz - 45kHz
S.P.L.	: 93dB/W (m)
Music Power	: 80W
Recommended Cross-over Frequency	: more than 3.5kHz
Magnet Weight	: 27g (0.06 lb)
Net Weight	: 155g (0.34 lb)

Frequency Response / Impedance

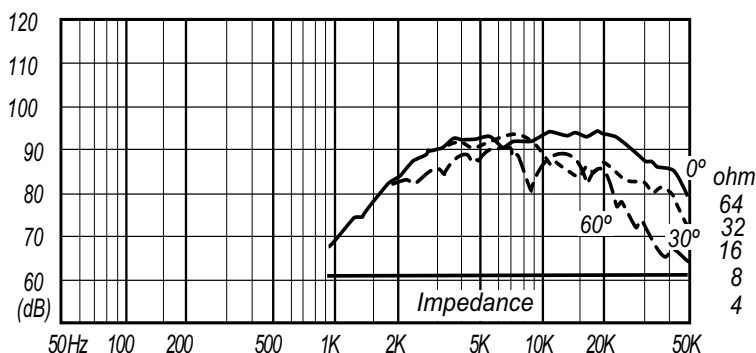

Configuration Example

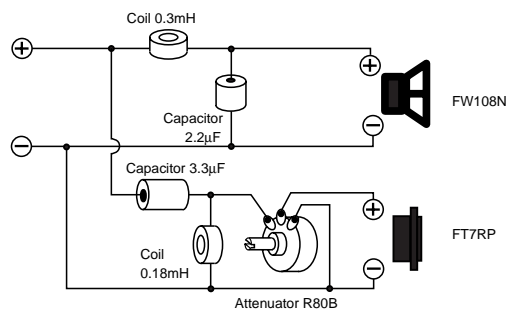

Dimensions & Mounting Information

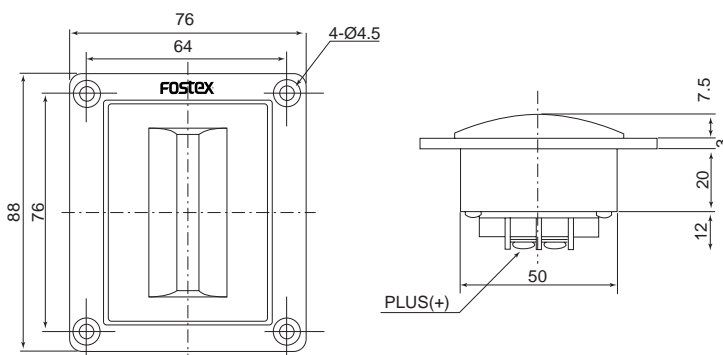



FT17H

Features

- High cost performance horn tweeter
- Well extended high frequency, 5kHz to 50kHz
- Shielded magnet circuit is employed

Specifications

&

Thiele/Small Parameters

Impedance	: 8 Ω
Reproduction Frequency Response	: 5 kHz - 50 kHz
S.P.L.	: 98.5 dB/W(m)
Power Handling	: 30 W (music)
Cutoff Frequency	: 2.6 kHz
Recommended Crossover Frequency	: 5 kHz or more
Magnet Weight	: 113.5 g / 0.25 lb
Net Weight	: 340 g / 0.75 lb



Frequency Response / Impedance

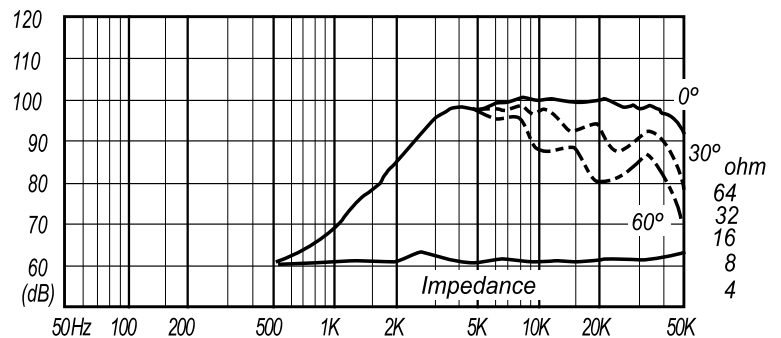

Configuration Example

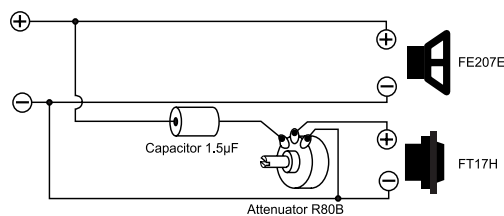

Dimensions & Mounting Information

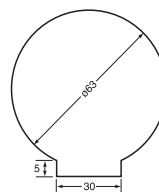
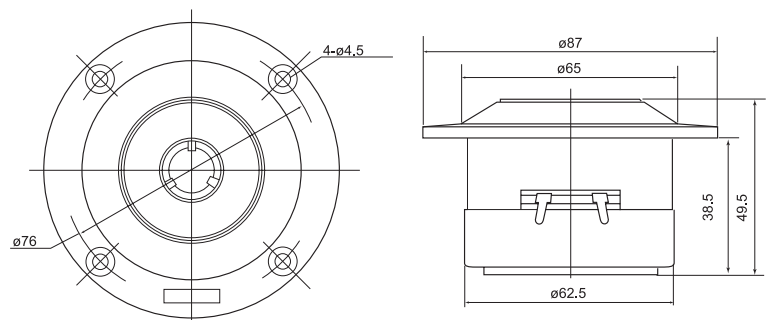

Overall Diameter	: 87 mm / 3.5 in
Baffle Hole Diameter	: 63 mm / 2.4 in
Depth	: 49.5 mm / 1.9 in

Features

- ◆ Dome Tweeter
- ◆ 8 ohm impedance
- ◆ 2kHz to 30kHz frequency response
- ◆ 90dB sensitivity at 1W/1m (3.3ft)
- ◆ 0.565kg (1.25 lb) net weight



Specifications

Impedance	: 8 ohm
Reproduction Frequency Response	: 2kHz - 30kHz
S.P.L.	: 90dB/W (m)
Music Power	: 40W
Recommended Cross-over Frequency	: more than 3kHz
Magnet Weight	: 171.3g (0.38 lb)
Net Weight	: 565g (1.25 lb)

Frequency Response / Impedance

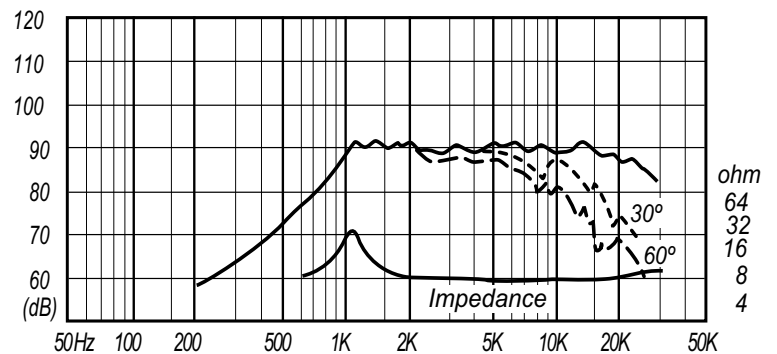

Configuration Example

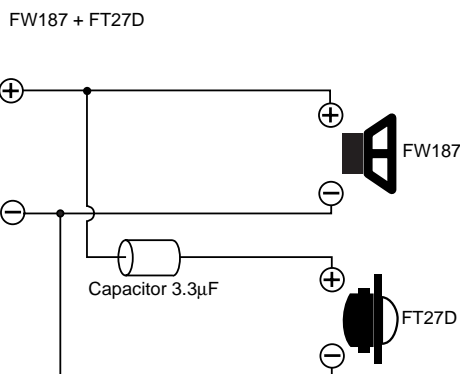

Dimensions & Mounting Information

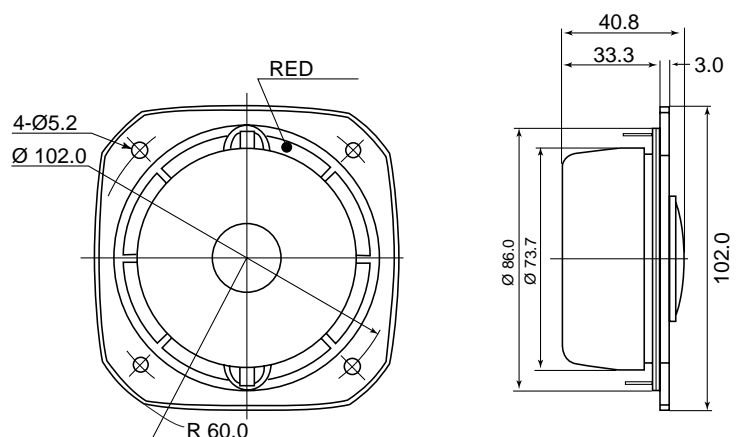

FT28D

Features

- ◆ Dome Tweeter
- ◆ 8 ohm impedance
- ◆ 1kHz to 50kHz frequency response
- ◆ 90dB sensitivity at 1W/1m (3.3ft)
- ◆ 0.528kg (1.164 lb) net weight

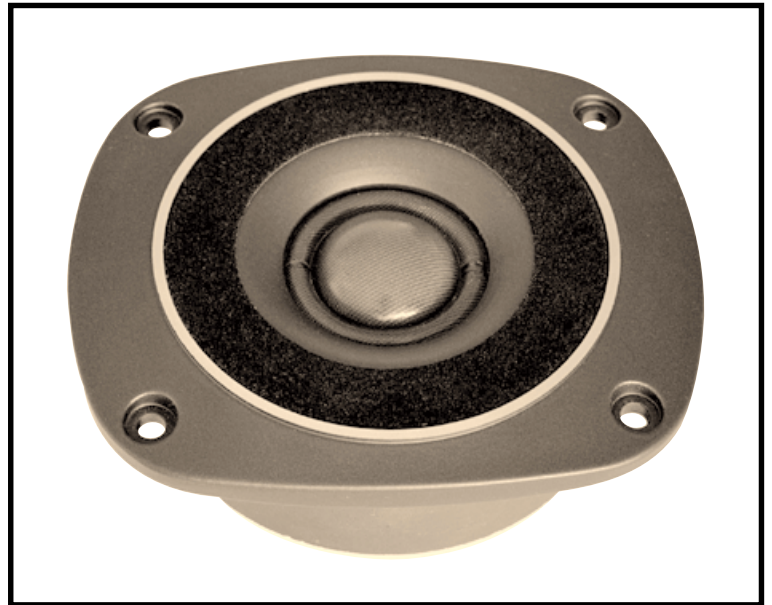

Specifications

Impedance	: 8 ohm
Reproduction Frequency Response	: 1kHz - 50kHz
S.P.L.	: 90dB/W (m)
Music Power	: 40W
Recommended Cross-over Frequency	: more than 2kHz
Magnet Weight	: 228.3g (0.503 lb)
Net Weight	: 528g (1.164 lb)

Frequency Response / Impedance

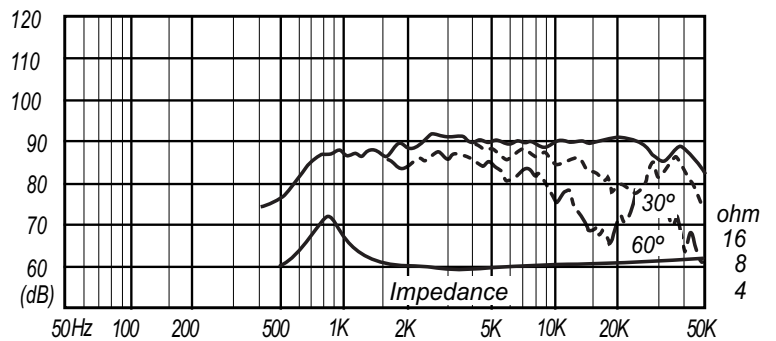

Configuration Example

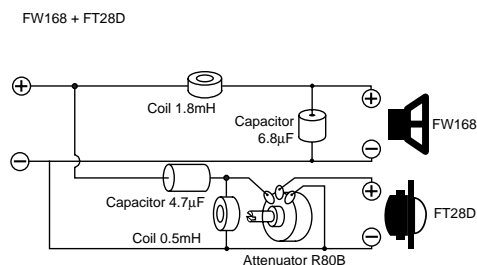

Dimensions & Mounting Information

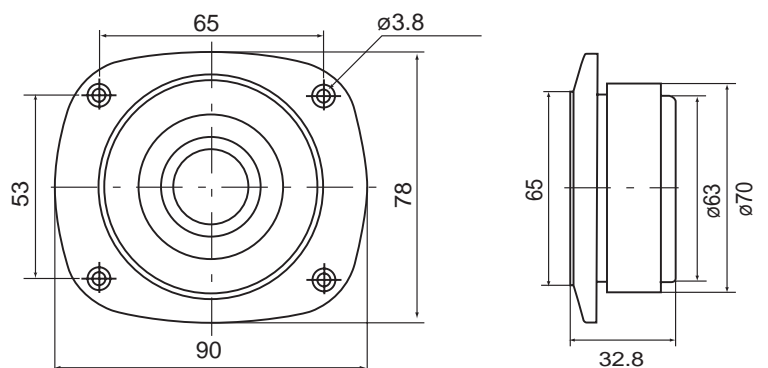



FT33RP

Features

- ◆ RP Tweeter
- ◆ 8 ohm impedance
- ◆ 2kHz to 45kHz frequency response
- ◆ 91dB sensitivity at 1W/1m (3.3ft)
- ◆ 0.387kg (0.85 lb) net weight



Specifications

Impedance	: 8 ohm
Reproduction Frequency Response	: 2kHz - 45kHz
S.P.L.	: 91dB/W (m)
Music Power	: 60W
Recommended Cross-over Frequency	: more than 3.5kHz
Magnet Weight	: 29g (0.06 lb)
Net Weight	: 387g (0.85 lb)

Frequency Response / Impedance

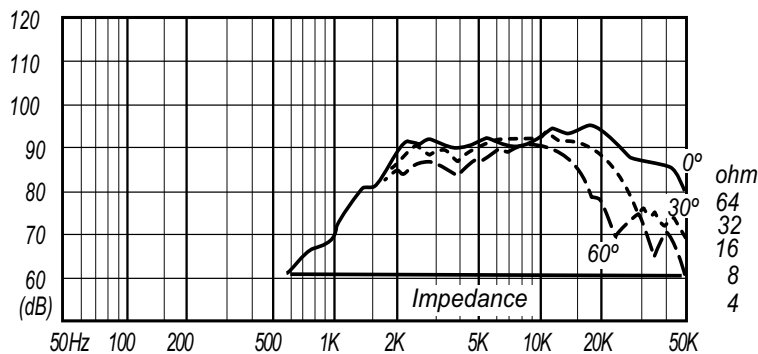

Configuration Example

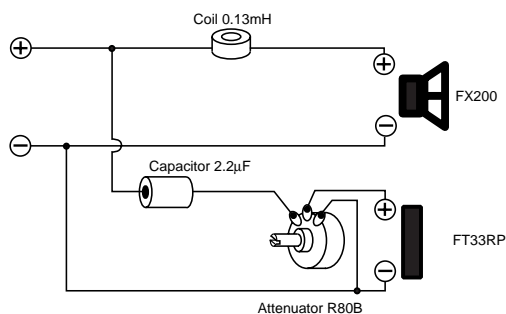

Dimensions & Mounting Information

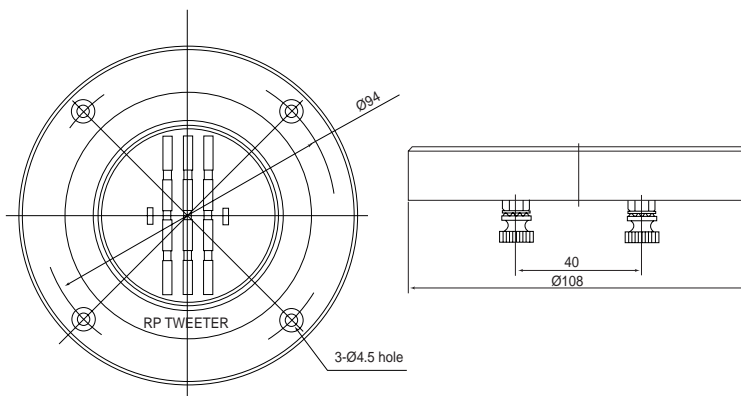

FT48D

Features

- ◆ Dome Tweeter
- ◆ 8 ohm impedance
- ◆ 800Hz to 30kHz frequency response
- ◆ 93dB sensitivity at 1W/1m (3.3ft)
- ◆ 0.978kg (2.15 lb) net weight

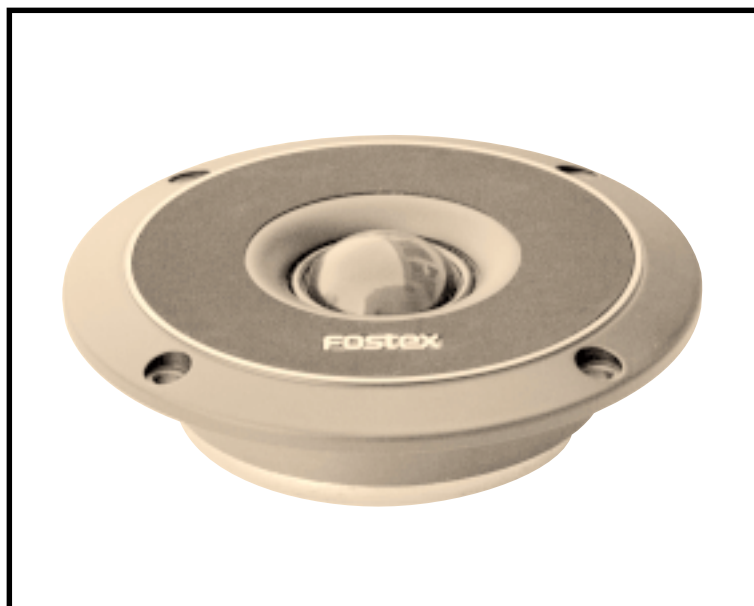

Specifications

Impedance	: 8 ohm
Reproduction Frequency Response	: 800Hz - 30kHz
S.P.L.	: 93dB/W (m)
Music Power	: 50W
Recommended Cross-over Frequency	: more than 900Hz
Magnet Weight	: 300g (0.66 lb)
Net Weight	: 978g (2.16 lb)

Frequency Response / Impedance

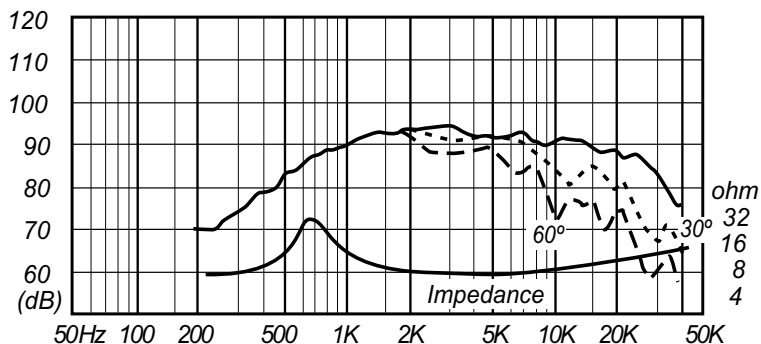

Configuration Example

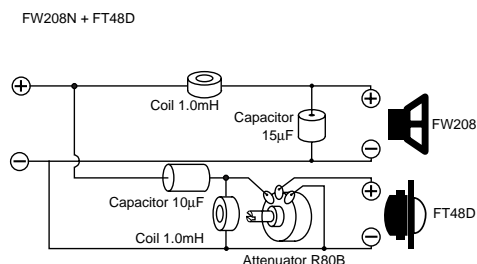

Dimensions & Mounting Information

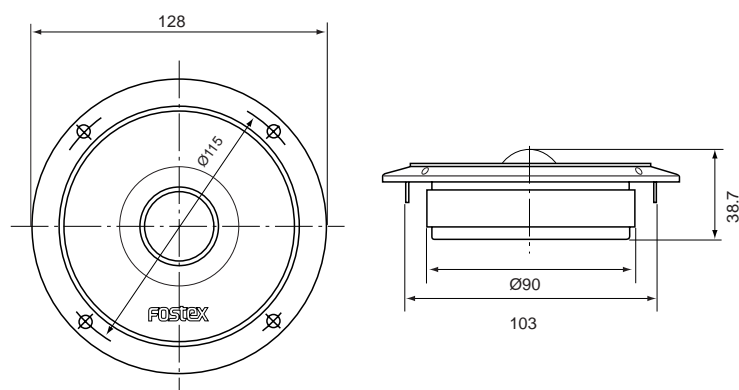

FT66H

Features

- ◆ Ring diaphragm Tweeter
- ◆ 8 ohm impedance
- ◆ 2.5kHz to 22kHz frequency response
- ◆ 105dB sensitivity at 1W/1m (3.3ft)
- ◆ 1.15kg (2.54 lb) net weight

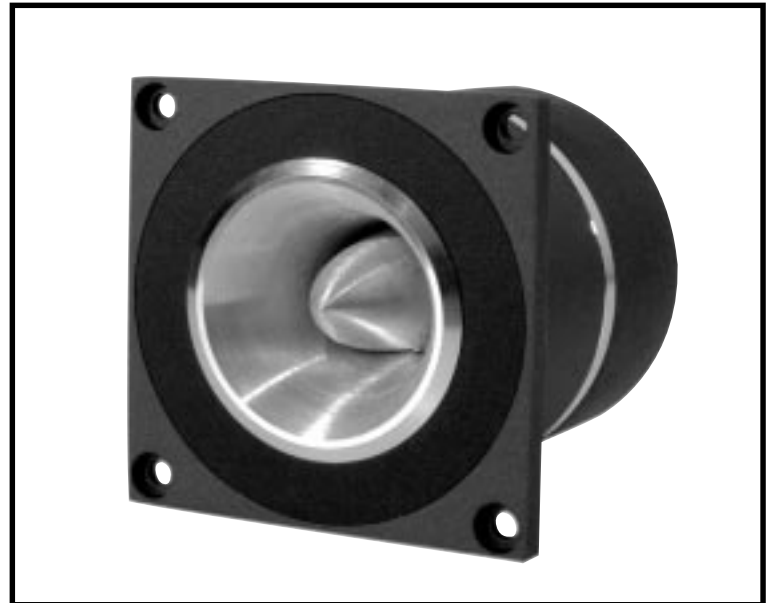

Specifications

Impedance	: 8 ohm
Reproduction Frequency Response	: 2.5kHz - 22kHz
S.P.L.	: 105dB/W (m)
Music Power	: 70W
Cutoff Frequency	: 2.3kHz
Recommended Cross-over Frequency	: more than 3.5kHz
Magnet (alnico)Weight	: 100g (0.22 lb)
Net Weight	: 1.15kg (2.54 lb)

Frequency Response / Impedance

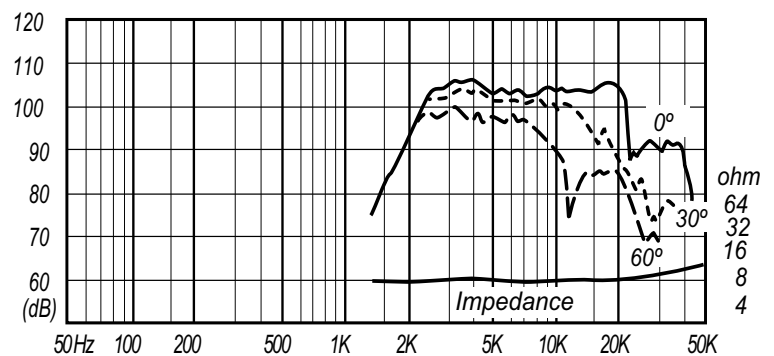

Configuration Example

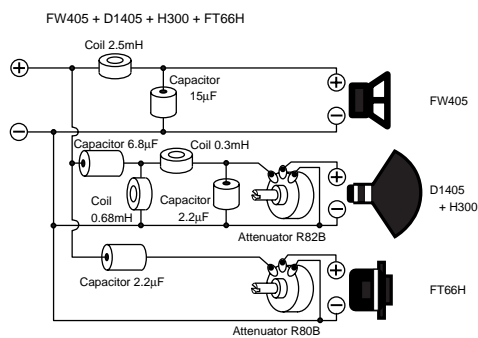

Dimensions & Mounting Information

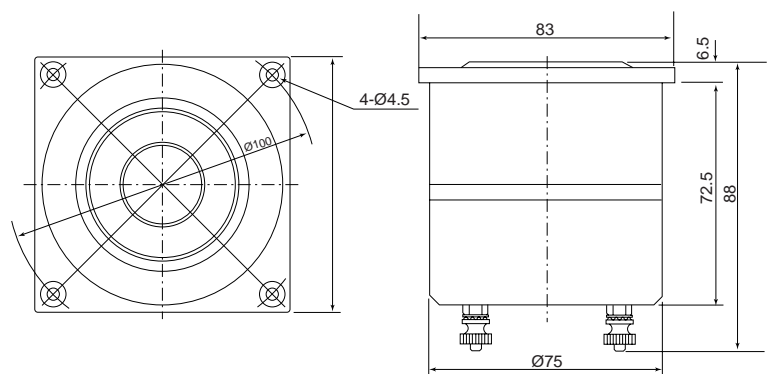

FT96H

Features

- ◆ Horn Super Tweeter
- ◆ 8 ohm impedance
- ◆ 4kHz to 33kHz frequency response
- ◆ 100dB sensitivity at 1W/1m (3.3ft)
- ◆ 0.6kg (1.32 lb) net weight



Specifications

Impedance	: 8 ohm
Reproduction Frequency Response	: 4kHz - 33kHz
S.P.L.	: 100dB/W (m)
Music Power	: 50W
Cutoff Frequency	: 3.9kHz
Recommended Cross-over Frequency	: more than 8kHz
Magnet (alnico)Weight	: 34g (0.07 lb)
Net Weight	: 600g (1.32 lb)

Frequency Response / Impedance

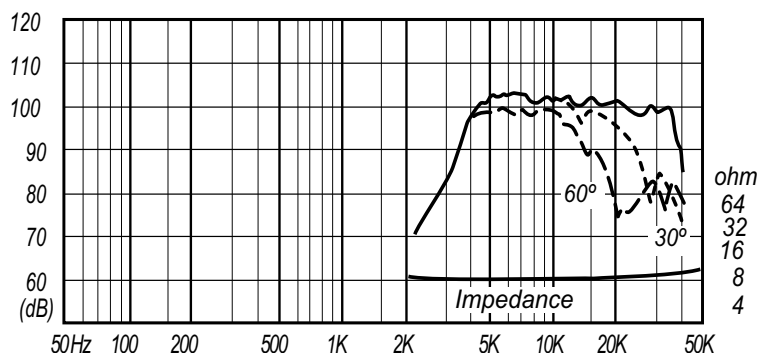

Configuration Example

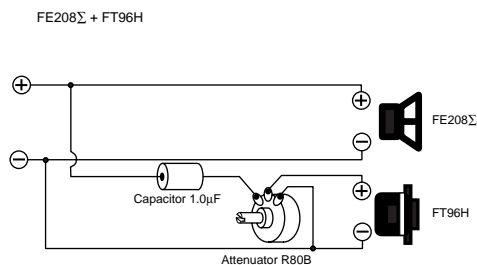

Dimensions & Mounting Information

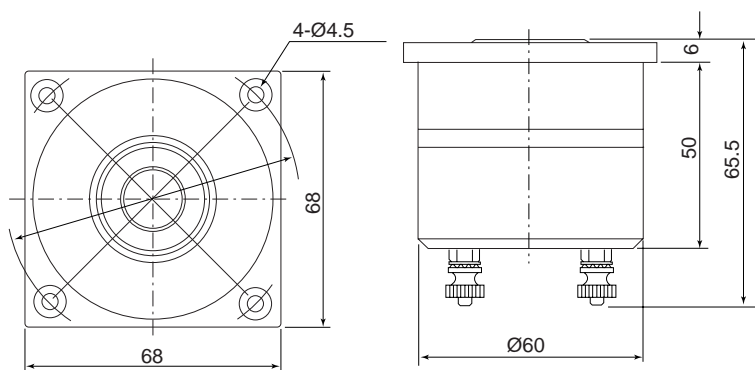



FW108N

Features

- ◆ 100mm (4 in) cone type full range
- ◆ 8 ohm impedance
- ◆ fo to 10kHz frequency response
- ◆ 86dB sensitivity at 1W/1m (3.3ft)
- ◆ 1.695kg (3.7373 lb) net weight



Specifications & Thiele/Small Parameters

Impedance	: 8 ohm
Minimum Frequency Response	: 55Hz
Reproduction Frequency Response	: fo - 10kHz
S.P.L.	: 86dB/W (m)
Rated Input	: 17W
Music Power	: 50W
Equivalent Diaphragm Radius	: 40mm (1.6 in)
Equivalent Mass	: 6.9g (0.015 lb)
Magnet Weight	: 500g (1.102 lb)
Net Weight	: 1.7kg (3.74 lb)
Fs	: 55Hz
Re	: 6.3 ohm
Qts	: 0.26
Qms	: 8.8
Qes	: 0.27
Vas	: 4.09 L
Xmax	: 1.9mm (0.075 in)
no	: 0.237%

Frequency Response / Impedance

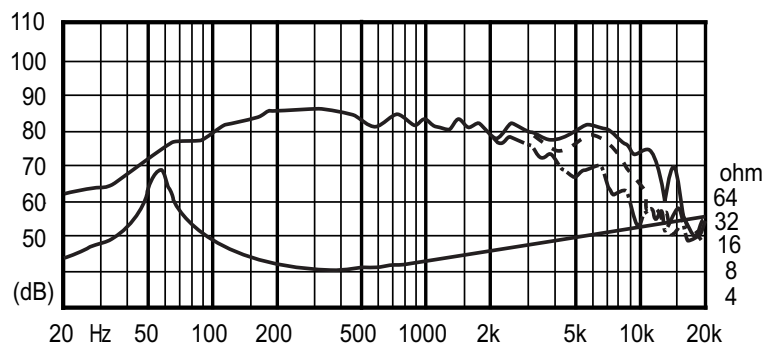

Dimensions & Mounting Information

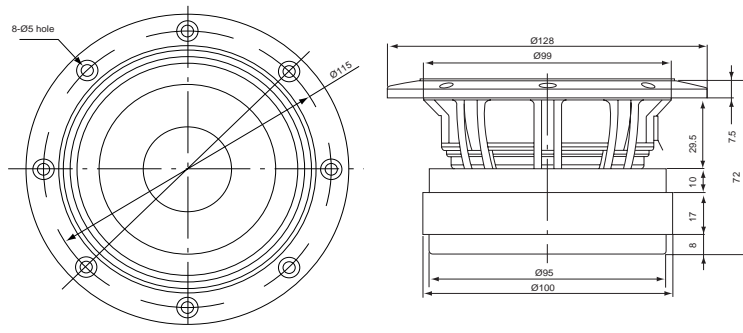

FW127

Features

- ◆ 120mm (4.5 in) cone type full range
- ◆ 8 ohm impedance
- ◆ fo to 10kHz frequency response
- ◆ 87dB sensitivity at 1W/1m (3.3ft)
- ◆ 1.12kg (2.47 lb) net weight



Specifications & Thiele/Small Parameters

Impedance	: 8 ohm
Minimum Frequency Response	: 45Hz
Reproduction Frequency Response	: fo - 10kHz
S.P.L.	: 87dB/W (m)
Rated Input	: 17W
Music Power	: 50W
Equivalent Diaphragm Radius	: 46mm (1.8 in)
Equivalent Mass	: 7g (0.015 lb)
Magnet Weight (main)	: 282.0g (0.62 lb)
(cancel)	: 101.2g (0.22 lb)
Net Weight	: 1.12kg (2.47 lb)
Fs	: 45Hz
Re	: 7.4 ohm
Qts	: 0.35
Qms	: 6.07
Qes	: 0.37
Vas	: 7.73 L
Xmax	: 1.85mm (0.073 in)
no	: 0.257%

Frequency Response / Impedance

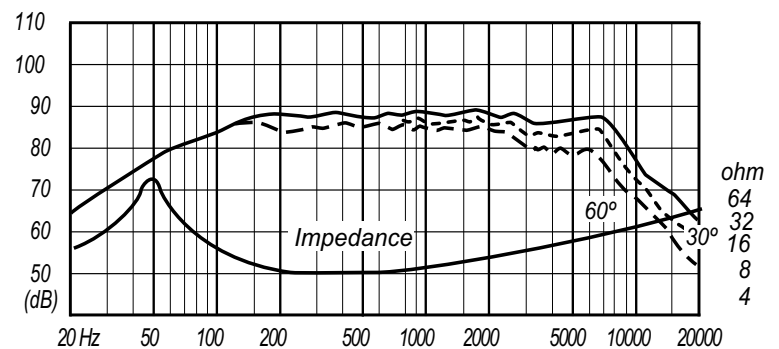

Dimensions & Mounting Information

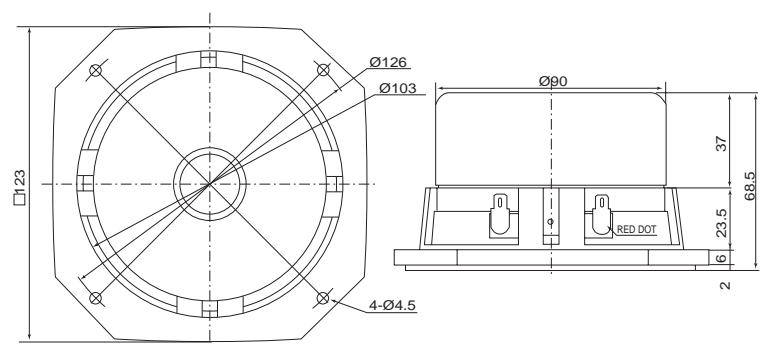



FW-series Hyperborilc Paraboloid Woofer

FW168HP

Features

- ◆ 160mm (6 in) cone type woofer
- ◆ 8 ohm impedance
- ◆ fo to 10kHz frequency response
- ◆ 90dB sensitivity at 1W/1m (3.3ft)
- ◆ 3.55kg (7.826 lb) net weight



Specifications & Thiele/Small Parameters

Impedance	: 8 ohm
Minimum Frequency Response	: 55Hz
Reproduction Frequency Response	: fo - 10kHz
S.P.L.	: 90dB/W (m)
Rated Input	: 34W
Music Power	: 100W
Equivalent Diaphragm Radius	: 61mm (2.402 in)
Equivalent Mass	: 19.5g (0.043 lb)
Magnet Weight	: 1.09kg (2.403 lb)
Net Weight	: 3.55kg (7.826 lb)
Fs	: 55Hz
Re	: 5.8 ohm
Qts	: 0.22
Qms	: 2.86
Qes	: 0.23
Vas	: 9.868 L
Xmax	: 1mm (0.039 in)
no	: 0.77%

Frequency Response / Impedance

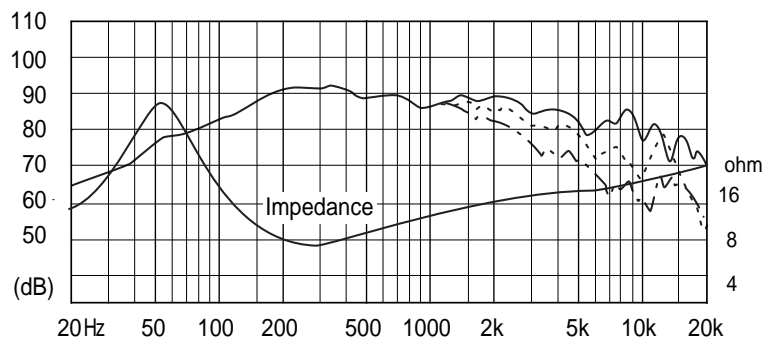

Dimensions & Mounting Information

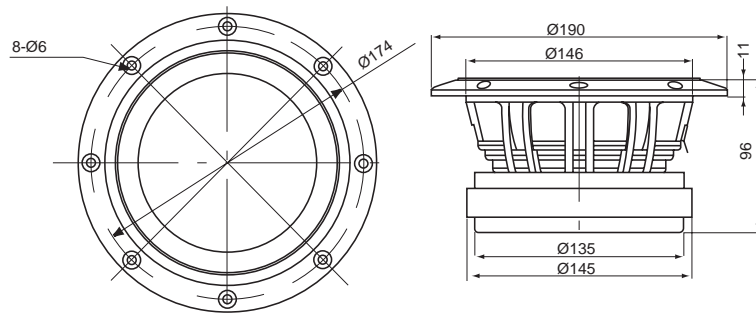



FW168N

Features

- ◆ 160mm (6.5 in) cone type full range
- ◆ 8 ohm impedance
- ◆ fo to 9kHz frequency response
- ◆ 89dB sensitivity at 1W/1m (3.3ft)
- ◆ 3.875kg (8.543 lb) net weight



Specifications & Thiele/Small Parameters

Impedance	: 8 ohm
Minimum Frequency Response	: 40Hz
Reproduction Frequency Response	: fo - 9kHz
S.P.L.	: 89dB/W (m)
Rated Input	: 34W
Music Power	: 100W
Equivalent Diaphragm Radius	: 65mm (2.56 in)
Equivalent Mass	: 28g (0.062 lb)
Magnet Weight	: 1090g (2.403 lb)
Net Weight	: 3.9kg (8.543 lb)
Fs	: 40Hz
Re	: 5.9 ohm
Qts	: 0.16
Qms	: 15.67
Qes	: 0.17
Vas	: 14.25 L
Xmax	: 0.5mm (0.020 in)
no	: 0.517%

Frequency Response / Impedance

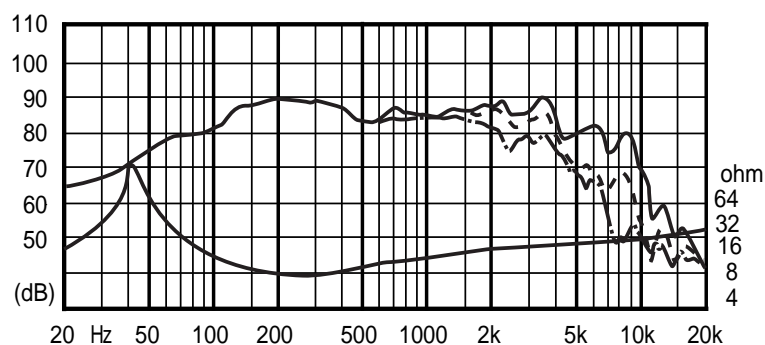

Dimensions & Mounting Information

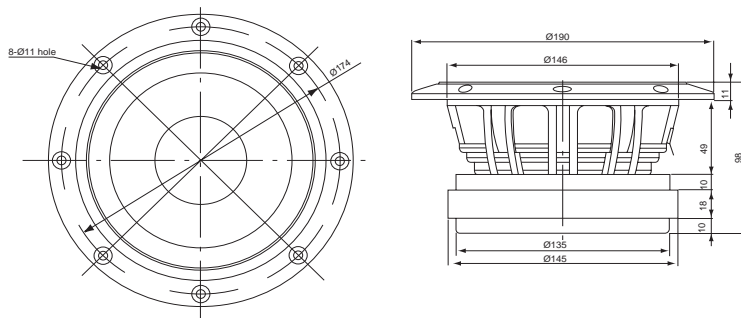

FW187

Features

- ◆ 180mm (7 in) cone type full range
- ◆ 8 ohm impedance
- ◆ fo to 5kHz frequency response
- ◆ 90dB sensitivity at 1W/1m (3.3ft)
- ◆ 2.8kg (6.17 lb) net weight



Specifications & Thiele/Small Parameters

Impedance	: 8 ohm
Minimum Frequency Response	: 30Hz
Reproduction Frequency Response	: fo - 5kHz
S.P.L.	: 90dB/W (m)
Rated Input	: 34W
Music Power	: 100W
Equivalent Diaphragm Radius	: 80mm (3.15 in)
Equivalent Mass	: 25g (0.055 lb)
Magnet Weight (main)	: 567.5g (1.25 lb)
(cancel)	: 263.9g (0.58 lb)
Net Weight	: 2.8kg (6.17 lb)
Fs	: 30Hz
Re	: 7.8 ohm
Qts	: 0.31
Qms	: 4.23
Qes	: 0.33
Vas	: 59.97 L
Xmax	: 4.0mm (0.15 in)
no	: 0.518%

Frequency Response / Impedance

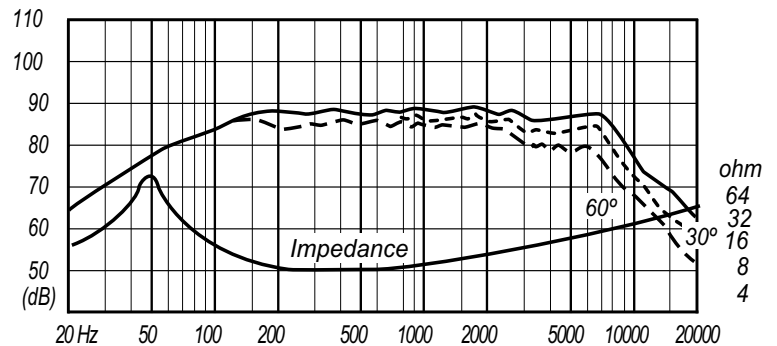

Dimensions & Mounting Information

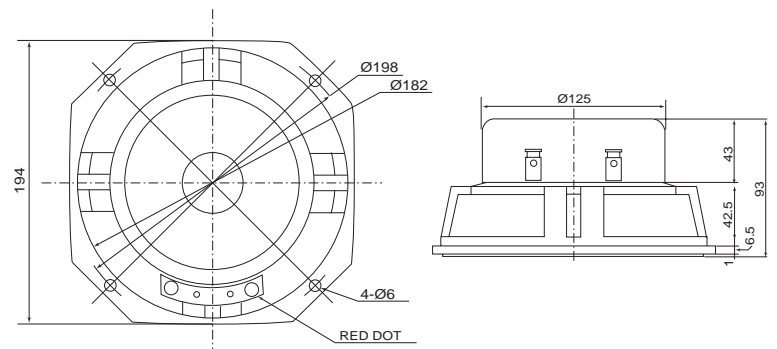



FW208N

Features

- ◆ 200mm (8 in) cone type full range
- ◆ 8 ohm impedance
- ◆ fo to 5kHz frequency response
- ◆ 90dB sensitivity at 1W/1m (3.3ft)
- ◆ 4.62kg (10.2 lb) net weight



Specifications & Thiele/Small Parameters

Impedance	: 8 ohm
Minimum Frequency Response	: 29Hz
Reproduction Frequency Response	: fo - 5kHz
S.P.L.	: 90dB/W (m)
Rated Input	: 34W
Music Power	: 100W
Equivalent Diaphragm Radius	: 81mm (3.19 in)
Equivalent Mass	: 40g (0.088 lb)
Magnet Weight	: 1.41kg (3.10 lb)
Net Weight	: 4.62kg (10.18 lb)
Fs	: 29Hz
Re	: 5.8 ohm
Qts	: 0.2
Qms	: 13.2
Qes	: 0.21
Vas	: 43.423 L
Xmax	: 6.5mm (0.256 lb)
no	: 0.485%

Frequency Response / Impedance



Dimensions & Mounting Information

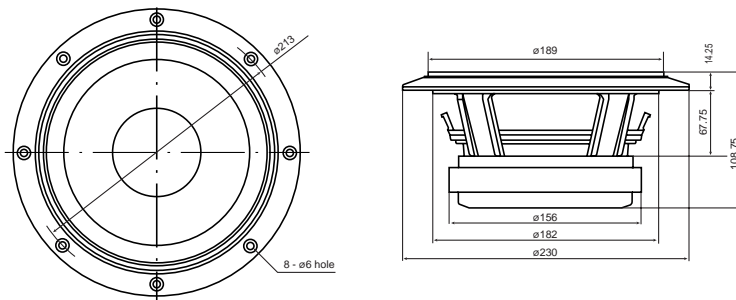



FW305

Features

- ◆ 300mm (12 in) cone type full range
- ◆ 8 ohm impedance
- ◆ fo to 3.5kHz frequency response
- ◆ 95dB sensitivity at 1W/1m (3.3ft)
- ◆ 5.0kg (11.023 lb) net weight



Specifications & Thiele/Small Parameters

Impedance	: 8 ohm
Minimum Frequency Response	: 25Hz
Reproduction Frequency Response	: fo - 3.5kHz
S.P.L.	: 95dB/W (m)
Rated Input	: 40W
Music Power	: 125W
Equivalent Diaphragm Radius	: 130mm (5.098 in)
Equivalent Mass	: 55g (0.121 lb)
Magnet Weight	: 1.41kg (3.108 lb)
Net Weight	: 5.0kg (11.023 lb)
Fs	: 25Hz
Re	: 6.6 ohm
Qts	: 0.25
Qms	: 2.73
Qes	: 0.28
Vas	: 254 L
Xmax	: 4.8mm (0.187 in)
no	: 1.4%

Frequency Response / Impedance

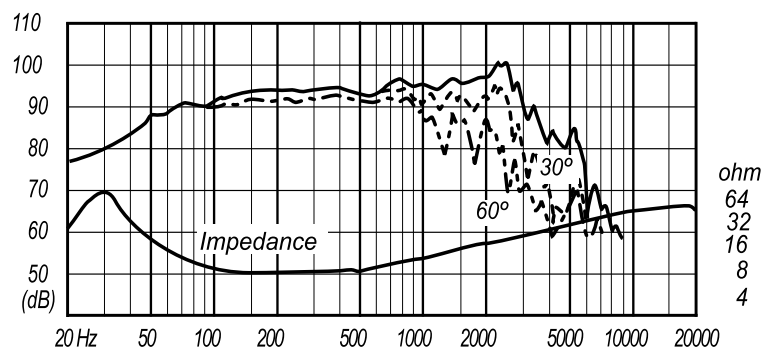

Dimensions & Mounting Information

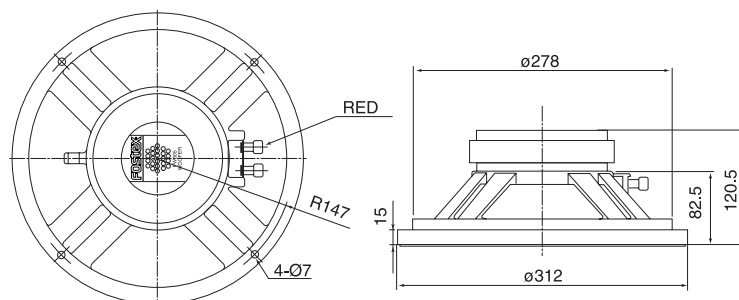



FW405

Features

- ◆ 400mm (16 in) cone type full range
- ◆ 8 ohm impedance
- ◆ fo to 2.5kHz frequency response
- ◆ 96dB sensitivity at 1W/1m (3.3ft)
- ◆ 7.8kg (17.196 lb) net weight



Specifications & Thiele/Small Parameters

Impedance	: 8 ohm
Minimum Frequency Response	: 20Hz
Reproduction Frequency Response	: fo - 2.5kHz
S.P.L.	: 96dB/W (m)
Rated Input	: 50W
Music Power	: 150W
Equivalent Diagram Radius	: 168.5mm(6.634 in)
Equivalent Mass	: 125g (0.276 lb)
Magnet Weight	: 1.82kg (4.015 lb)
Net Weight	: 7.8kg (17.196 lb)
Fs	: 20Hz
Re	: 6.8 ohm
Qts	: 0.34
Qms	: 4.99
Qes	: 0.36
Vas	: 595 L
Xmax	: 7.0mm (0.276 in)
no	: 1.27%

Frequency Response / Impedance

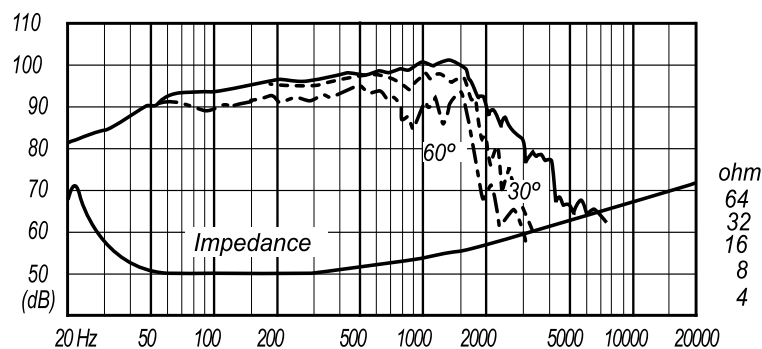

Dimensions & Mounting Information

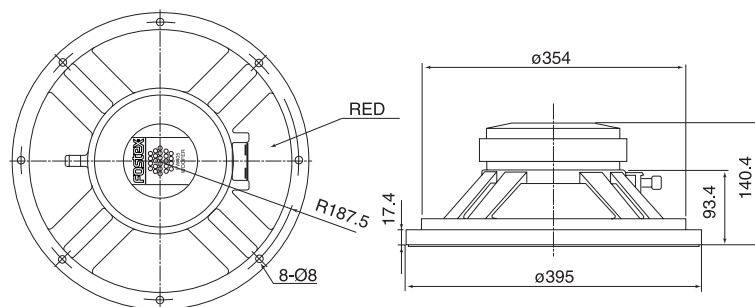

FW800N

Features

- ◆ 800mm (31.5 in) cone type super woofer
- ◆ 8 ohm impedance
- ◆ fo to 1.5kHz frequency response
- ◆ 96dB sensitivity at 1W/1m (3.3ft)
- ◆ 20.7kg (45.63 lb) net weight



Specifications & Thiele/Small Parameters

Impedance	: 8 ohm
Minimum Frequency Response	: 18Hz
Reproduction Frequency Response	: fo - 1.5kHz
S.P.L.	: 96dB/W (m)
Rated Input	: 150W
Music Power	: 450W
Equivalent Diaphragm Radius	: 357.5mm (14.07 in)
Equivalent Mass	: 440g (0.97 lb)
Magnet Weight	: 2.03kg (4.48 lb)
Net Weight	: 20.7kg (45.63 lb)
Fs	: 18Hz
Re	: 6.8 ohm
Qts	: 0.69
Qms	: 8.5
Qes	: 0.76
Vas	: 3,201.139 L
Xmax	: 2.3mm (0.09 in)
no	: 2.417x%

Frequency Response / Impedance

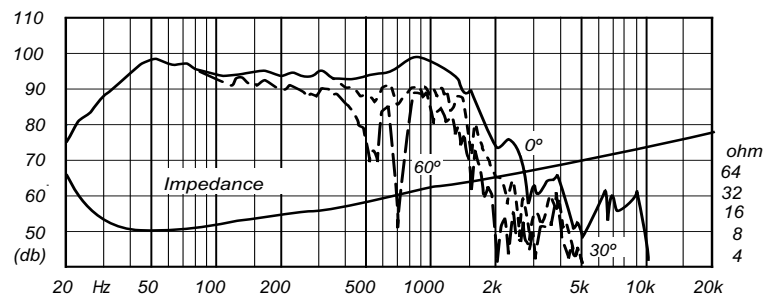

Dimensions & Mounting Information

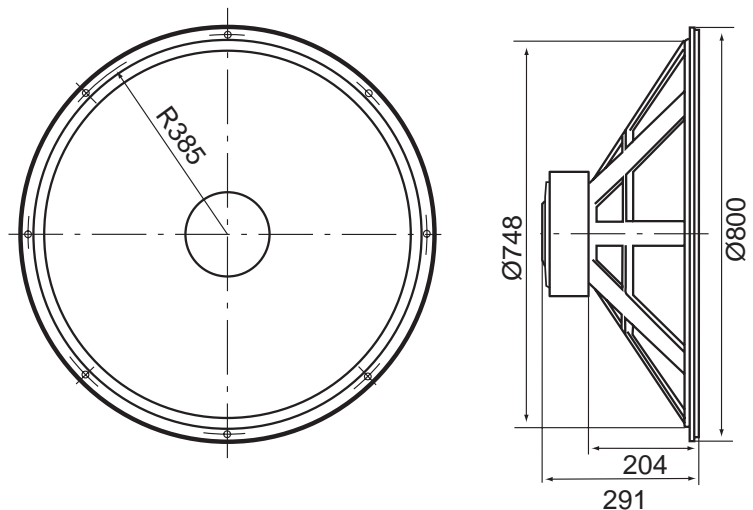



FX-series

FX120

Features

- ◆ 120mm (5 in) cone type full range
- ◆ 8 ohm impedance
- ◆ fo to 20kHz frequency response
- ◆ 89dB sensitivity at 1W/1m (3.3ft)
- ◆ 1.32kg (2.910 lb) net weight

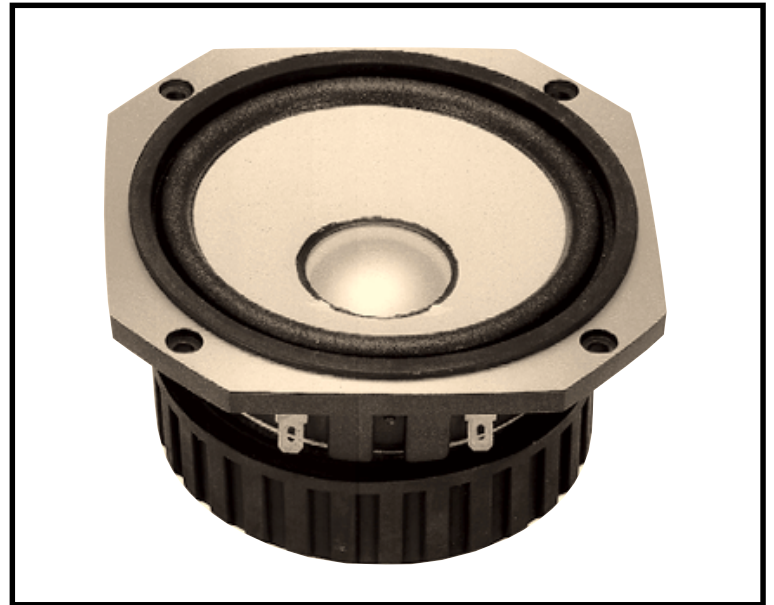

Specifications & Thiele/Small Parameters

Impedance	: 8 ohm
Minimum Frequency Response	: 65Hz
Reproduction Frequency Response	: fo - 20kHz
S.P.L.	: 89dB/W (m)
Rated Input	: 10W
Music Power	: 30W
Equivalent Diagram Radius	: 46mm (1.811 in)
Equivalent Mass	: 5.3g (0.012 lb)
Magnet Weight	: 330g (0.728 lb)
Net Weight	: 1.32kg (2.910 lb)
Fs	: 70Hz
Re	: 7.3 ohm
Qts	: 0.45
Qms	: 8.4
Qes	: 0.47
Vas	: 8.21 L
Xmax	: 2.0mm (0.079 in)
no	: 0.4%

Frequency Response / Impedance

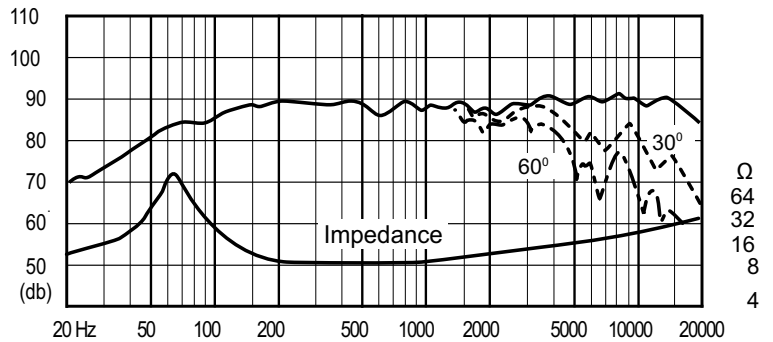

Dimensions & Mounting Information

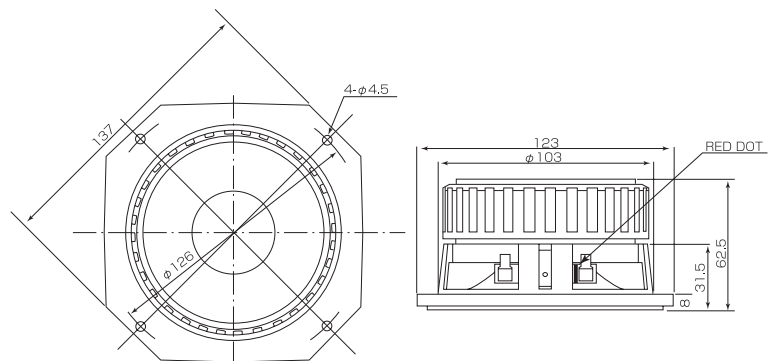



FX-series

FX200

Features

- ◆ 200mm (8 in) cone type full range
- ◆ 8 ohm impedance
- ◆ fo to 20kHz frequency response
- ◆ 92dB sensitivity at 1W/1m (3.3ft)
- ◆ 2.45kg (5.401 lb) net weight

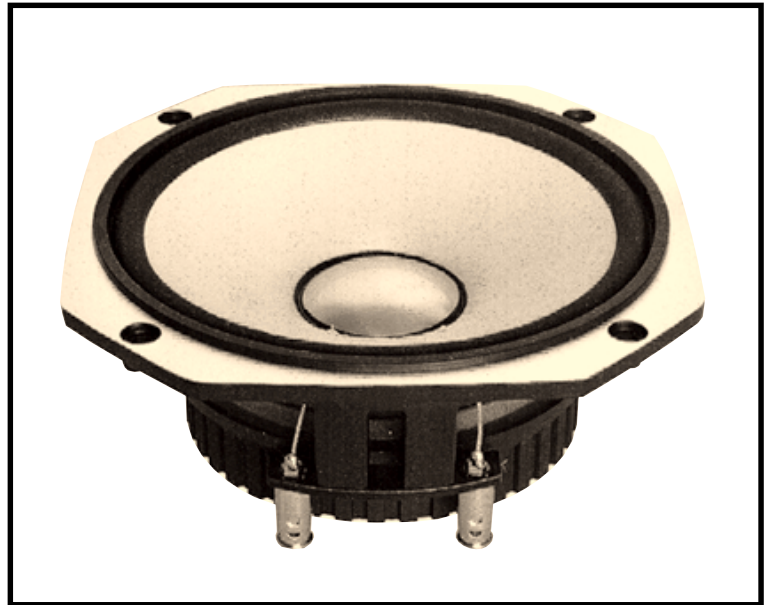

Specifications & Thiele/Small Parameters

Impedance	: 8 ohm
Minimum Frequency Response	: 38Hz
Reproduction Frequency Response	: fo - 20kHz
S.P.L.	: 92dB/W (m)
Rated Input	: 15W
Music Power	: 45W
Equivalent Diagram Radius	: 80mm (3.150 in)
Equivalent Mass	: 15.8g (0.035 lb)
Magnet Weight	: 721g (1.590 lb)
Net Weight	: 2.45kg (5.401 lb)
Fs	: 38Hz
Re	: 7.5 ohm
Qts	: 0.45
Qms	: 7.0
Qes	: 0.48
Vas	: 82.3 L
Xmax	: 1.0mm (0.039 in)
no	: 0.583%

Frequency Response / Impedance

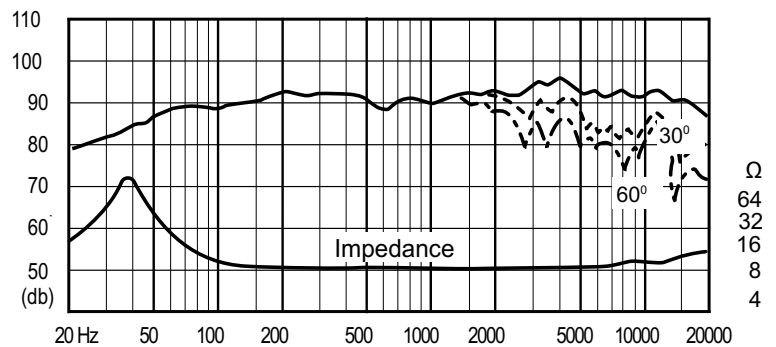

Dimensions & Mounting Information

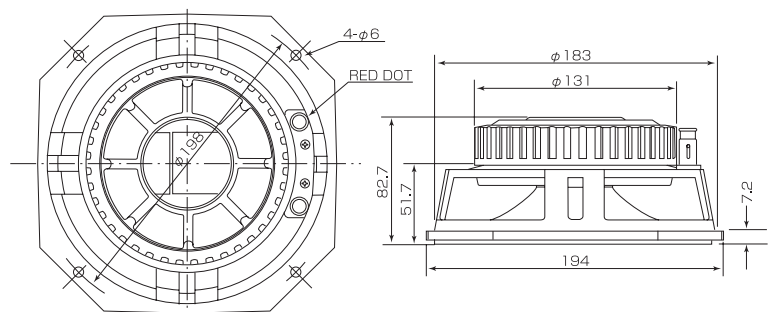

PS100

Features

- ◆ 100mm (4 in) cone type full range
- ◆ 8 ohm impedance
- ◆ fo to 16kHz frequency response
- ◆ 92dB sensitivity at 1W/1m (3.3ft)
- ◆ 0.630kg (1.389 lb) net weight



Specifications & Thiele/Small Parameters

Impedance	: 8 ohm
Minimum Frequency Response	: 200Hz
Reproduction Frequency Response	: fo - 16kHz
S.P.L.	: 92dB/W (m)
Continuous Rated Input	: 25W
Program Input Power	: 50W
Equivalent Diaphragm Radius	: 43mm (1.693 in)
Equivalent Mass	: 1.66g (0.004 lb)
Magnet Weight	: 193g (0.425 lb)
Net Weight	: 0.63kg (1.389 lb)
Fs	: 200Hz
Re	: 6.8 ohm
Qts	: 0.84
Qms	: 4.56
Qes	: 1.03
Vas	: 1.3 L
Xmax	: 0.5mm (0.020 in)
no	: 0.94%

Frequency Response / Impedance

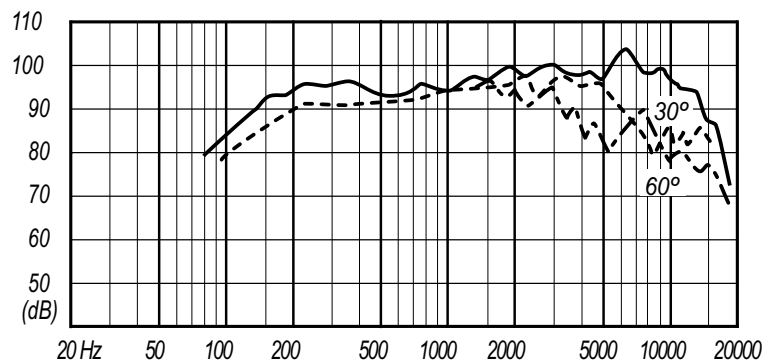

Dimensions & Mounting Information

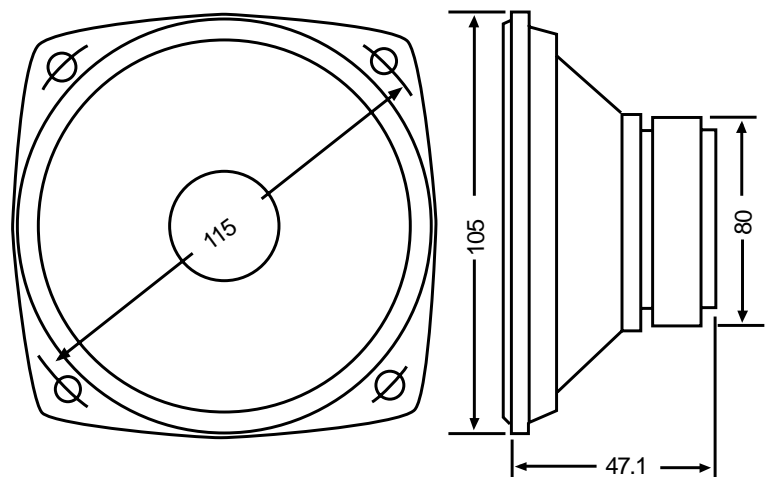



PS-series

PS200

Features

- ◆ 200mm (8 in) cone type full range
- ◆ 8 ohm impedance
- ◆ fo to 18kHz frequency response
- ◆ 96dB sensitivity at 1W/1m (3.3ft)
- ◆ 2.4kg (5.291 lb) net weight



Specifications & Thiele/Small Parameters

Impedance	: 8 ohm
Minimum Frequency Response	: 100Hz
Reproduction Frequency Response	: fo - 18kHz
S.P.L.	: 96dB/W (m)
Continuous Rated Input	: 40W
Program Input Power	: 80W
Equivalent Diaphragm Radius	: 84mm (3.307 in)
Equivalent Mass	: 11g (0.024 lb)
Magnet Weight	: 850g (1.874 lb)
Net Weight	: 2.4kg (5.291 lb)
Fs	: 100Hz
Re	: 6.7 ohm
Qts	: 0.86
Qms	: 10.72
Qes	: 0.94
Vas	: 17.3 L
Xmax	: 1.3mm (0.051 in)
no	: 1.8%

Frequency Response / Impedance

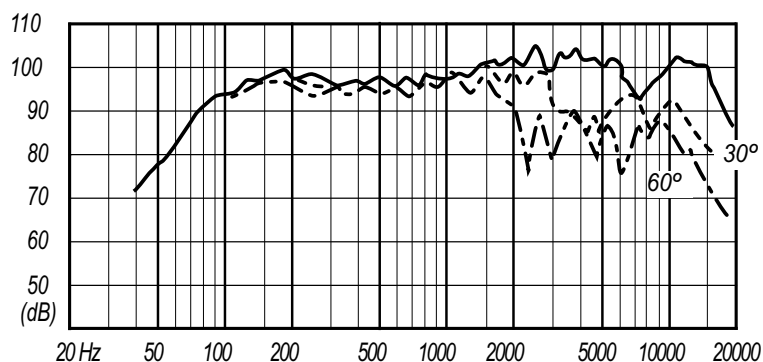

Dimensions & Mounting Information

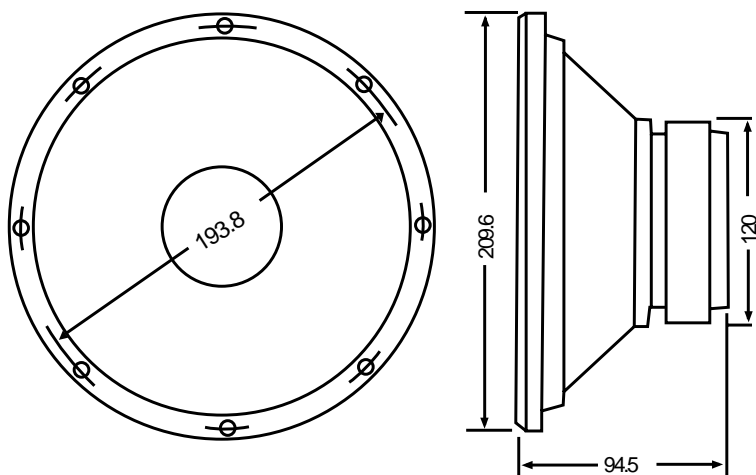

PS300

Features

- ◆ 300mm (12 in) cone type full range
- ◆ 8 ohm impedance
- ◆ fo to 18kHz frequency response
- ◆ 98dB sensitivity at 1W/1m (3.3ft)
- ◆ 5.1kg (11.243 lb) net weight



Specifications & Thiele/Small Parameters

Impedance	: 8 ohm
Minimum Frequency Response	: 58Hz
Reproduction Frequency Response	: fo - 18kHz
S.P.L.	: 98dB/W (m)
Continuous Rated Input	: 75W
Program Input Power	: 150W
Equivalent Diaphragm Radius	: 135mm (5.315 in)
Equivalent Mass	: 35g (0.077 lb)
Magnet Weight	: 1410g (3.108 lb)
Net Weight	: 5.1kg (11.243 lb)
Fs	: 58Hz
Re	: 7.2 ohm
Qts	: 0.86
Qms	: 10.99
Qes	: 0.93
Vas	: 102.2 L
Xmax	: 1.9mm (0.075 in)
no	: 2.06%

Frequency Response / Impedance

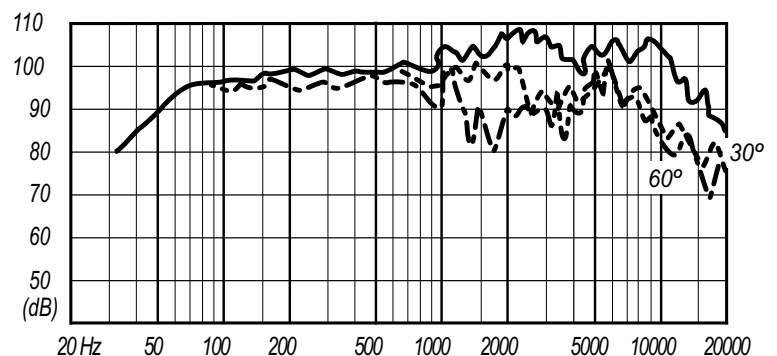

Dimensions & Mounting Information

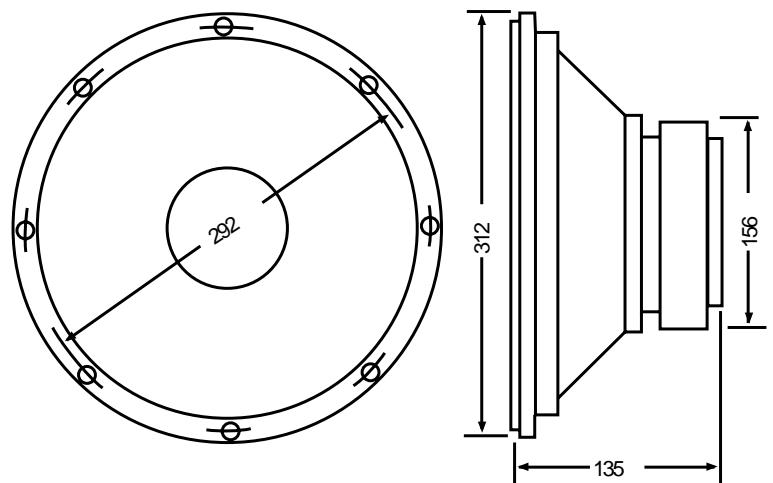

T90A

Features

- ◆ Horn Super Tweeter
- ◆ 8 ohm impedance
- ◆ 5kHz to 35kHz frequency response
- ◆ 106dB sensitivity at 1W/1m (3.3ft)
- ◆ 0.8kg (1.76 lb) net weight



Specifications

Impedance	: 8 ohm
Reproduction Frequency Response	: 5kHz - 35kHz
S.P.L.	: 106dB/W (m)
Music Power	: 50W
Cutoff Frequency	: 3.6kHz
Recommended Cross-over Frequency	: more than 7kHz (12dB/Oct.)
Magnet (alnico)Weight	: 100g (0.22 lb)
Net Weight	: 800g (1.76 lb)

Frequency Response / Impedance

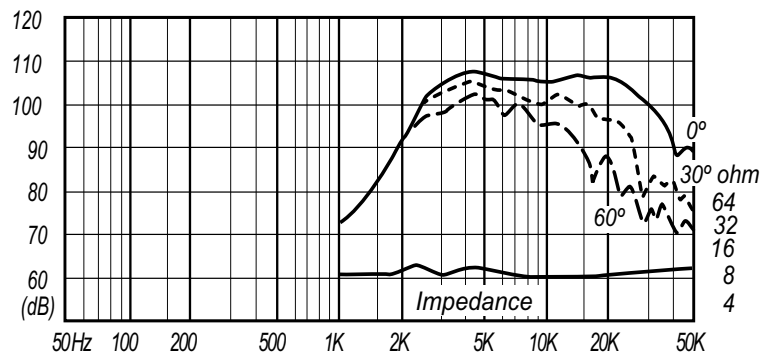

Configuration Example

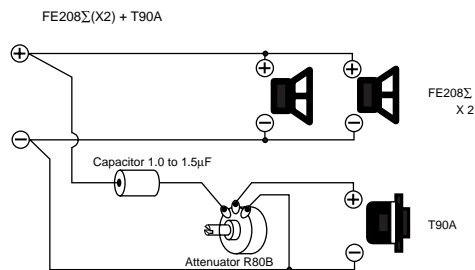

Dimensions & Mounting Information

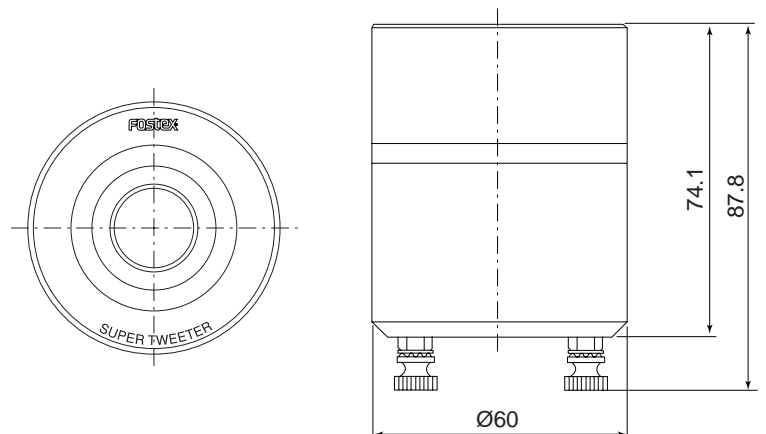

T500A

Features

- ◆ Horn Super Tweeter
- ◆ 8 ohm impedance
- ◆ 2kHz to 25kHz frequency response
- ◆ 102dB sensitivity at 1W/1m (3.3ft)
- ◆ 4.7kg (10.36 lb) net weight



Specifications

Impedance	: 8 ohm
Reproduction Frequency Response	: 2kHz - 25kHz
S.P.L.	: 102dB/W (m)
Music Power	: 50W
Cutoff Frequency	: 2.5kHz
Recommended Cross-over Frequency	: more than 5kHz
Magnet Weight	: 340g (0.750 lb)
Net Weight	: 4.7kg (10.362 lb)

Frequency Response / Impedance

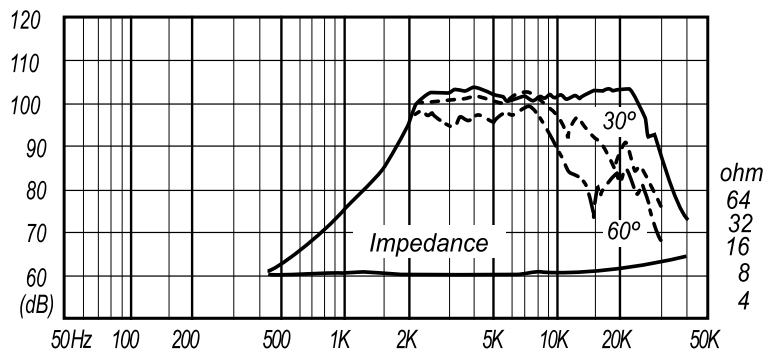

Dimensions & Mounting Information

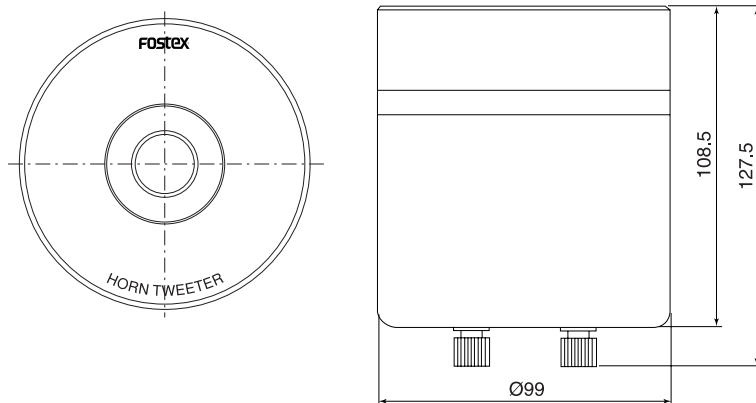

T900A

Features

- ◆ Horn Super Tweeter
- ◆ 8 ohm impedance
- ◆ 5kHz to 38kHz frequency response
- ◆ 106dB sensitivity at 1W/1m (3.3ft)
- ◆ 3.55kg (7.826 lb) net weight

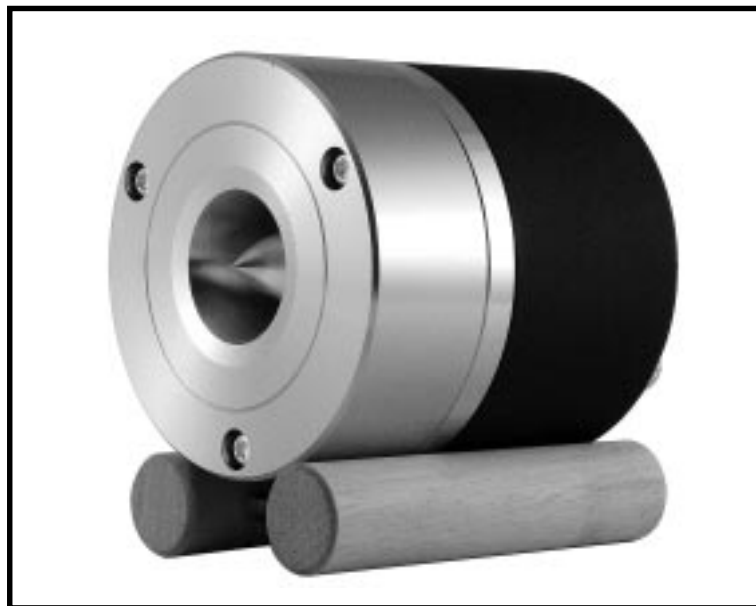

Specifications

Impedance	: 8 ohm
Reproduction Frequency Response	: 5kHz - 38kHz
S.P.L.	: 106dB/W (m)
Music Power	: 60W
Cutoff Frequency	: 3.6kHz
Recommended Cross-over Frequency	: more than 7kHz
Magnet Weight	: 240g (0.529 lb)
Net Weight	: 3.5kg (7.826 lb)

Frequency Response / Impedance

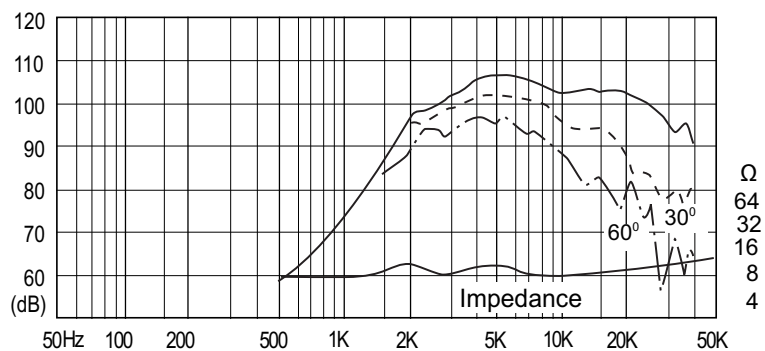

Dimensions & Mounting Information

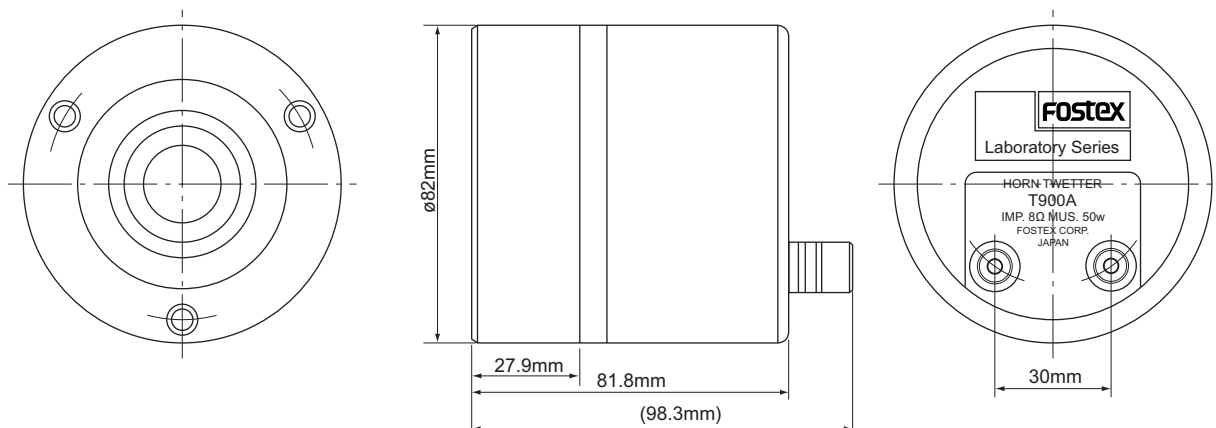

T925A

Features

- ◆ Horn Super Tweeter
- ◆ 8 ohm impedance
- ◆ 5kHz to 40kHz frequency response
- ◆ 108dB sensitivity at 1W/1m (3.3ft)
- ◆ 2kg (4.41 lb) net weight



Specifications

Impedance	: 8 ohm
Reproduction Frequency Response	: 5kHz - 40kHz
S.P.L.	: 108dB/W (m)
Music Power	: 50W
Cutoff Frequency	: 3.5kHz
Recommended Cross-over Frequency	: more than 6kHz (12dB/Oct.)
Magnet (alnico)Weight	: 240g (0.53 lb)
Net Weight	: 2kg (4.41 lb)

Frequency Response / Impedance

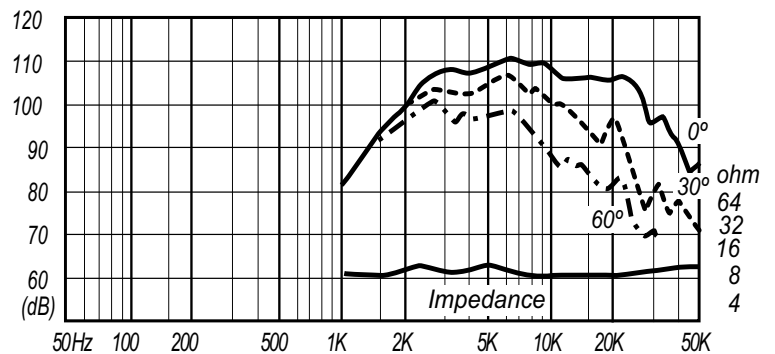

Configuration Example

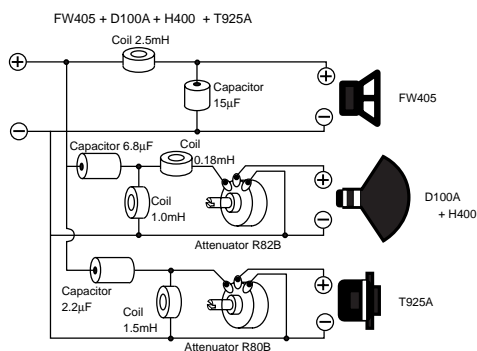

Dimensions & Mounting Information

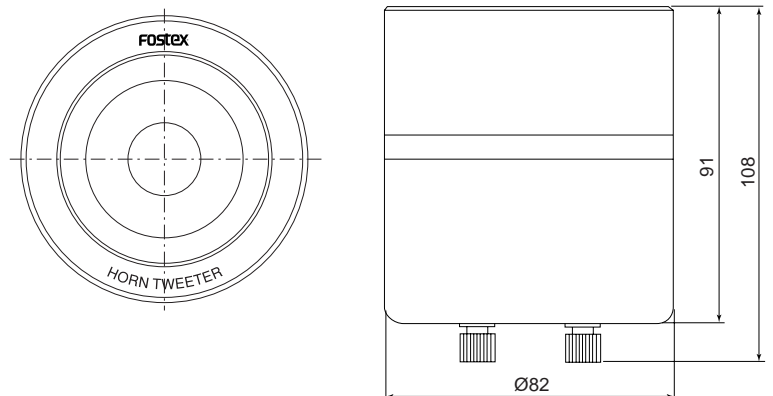

W300AII

Features

- 300mm (12in) cone type woofer
- $\varnothing 76\text{mm}/1.1\text{kg}$ larger alnico magnet
- Fine-ceramics multi-coated cone
- fo to 3kHz frequency response



Specifications

&

Thiele/Small Parameters

Size	:	300 mm / 12 in
Voice Coil Diameter	:	80 mm / 3 in
Cast / Stamped	:	Cast
Impedance	:	8 Ω
Reproduction Frequency Response	:	fs - 3.0 kHz
Sound Pressure Level	:	93 dB/W(m)
Rated Input	:	50 W
Music Power	:	150W
Magnet Material	:	Alnico
Magnet Weight	:	
(main)	:	1,100 g / 2.42 lb
(cancel)	:	g / lb
Net Weight	:	6,300 g / 13.9 lb

Frequency Response / Impedance

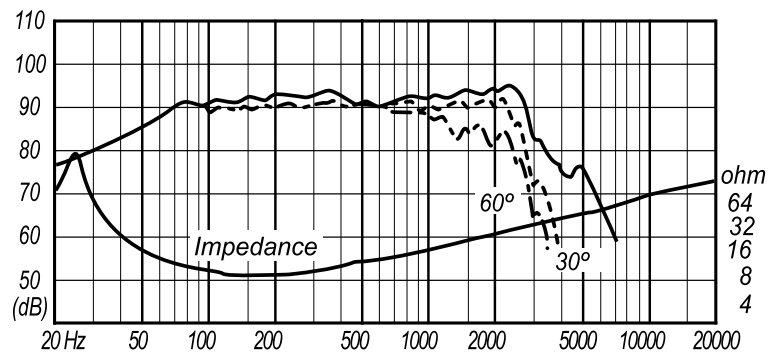

a	:	131 mm
D	:	262 mm
Sd	:	0.0539 m ²
Zn	:	8 Ω
Fs	:	25 Hz
Re	:	7.0 Ω
Le	:	0.1 mH
Qms	:	9.17
Qes	:	0.29
Qts	:	0.28
Mms	:	92.7 g
BL	:	18.75 Telsa/m
Vas	:	227.01 L
Xmax	:	6.5 mm
Eff/ $\eta 0$:	1.20 %
Cms	:	0.056 mm/N
EBP	:	86

Dimensions & Mounting Information

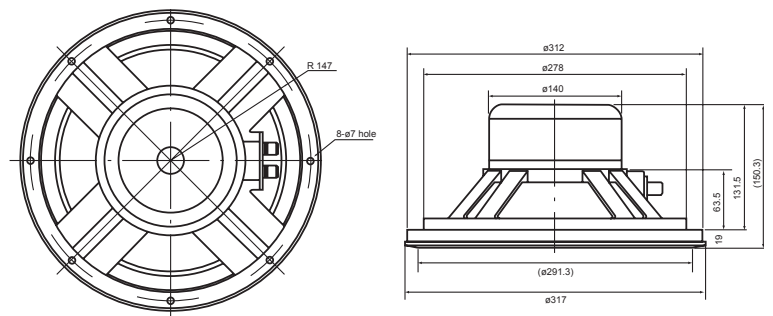

Overall Diameter	:	317 mm / 12 in
Baffle Hole Diameter	:	278 mm / 11 in
Depth	:	180 mm / in

W400AII

Features

- 400mm (16in) cone type woofer
- ø118mm/3.1kg larger alnico magnet
- Fine-ceramics multi-coated cone
- fo to 2.5kHz frequency response



Specifications & Thiele/Small Parameters

Size	:	400 mm / 16 in
Voice Coil Diameter	:	100 mm / 2.5 in
Cast / Stamped	:	Cast
Impedance	:	8 Ω
Reproduction Frequency Response	:	fs - 2.5 kHz
Sound Pressure Level	:	97 dB/W(m)
Rated Input	:	75 W
Music Power	:	200W
Magnet Material	:	Alnico
Magnet Weight	:	
(main)	:	3,100 g / 6.834 lb
(cancel)	:	n/a g / n/a lb
Net Weight	:	15,200 g / 33.51 lb

a	:	160 mm
D	:	337 mm
Sd	:	0.0892 m ²
Zn	:	8 Ω
Fs	:	25 Hz
Re	:	6.8 Ω
Le	:	0.13 mH
Qms	:	14.94
Qes	:	0.32
Qts	:	0.32
Mms	:	134.50 g
BL	:	21.19 Telsa/m
Vas	:	312.30 L
Xmax	:	7.0 mm
Eff/η0	:	1.46 %
Cms	:	0.028 mm/N
EBP	:	78

Frequency Response / Impedance

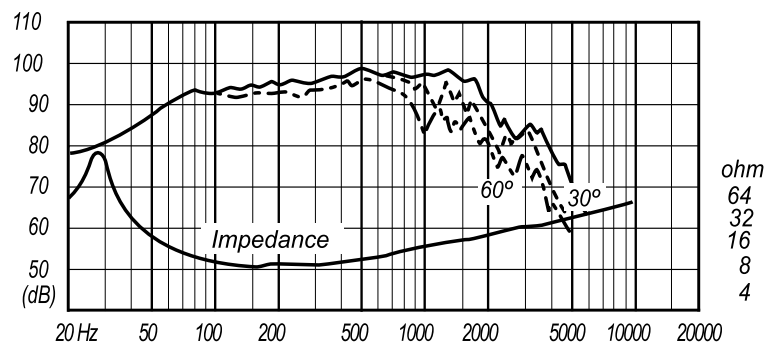

Dimensions & Mounting Information

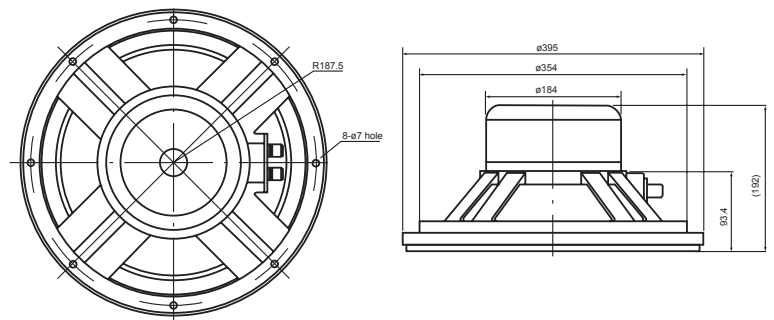

Overall Diameter	:	396 mm / 16 in
Baffle Hole Diameter	:	354 mm / 14 in
Depth	:	192 mm / 7.5 in

H200

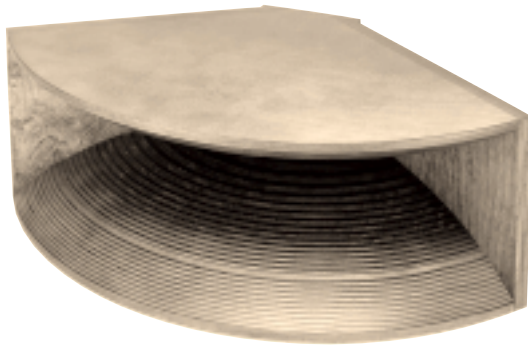

Specifications

Type	: Radial Horn
Cutoff Frequency	: 240kHz
Throat Diameter	: 50.8 mm (2 in)
Dimensions W	: 675 mm (26.57 in)
H	: 230 mm (9.05 in)
D	: 383 mm (15.07 in)
Net Weight	: 18 kg (39.683 lb)

H300

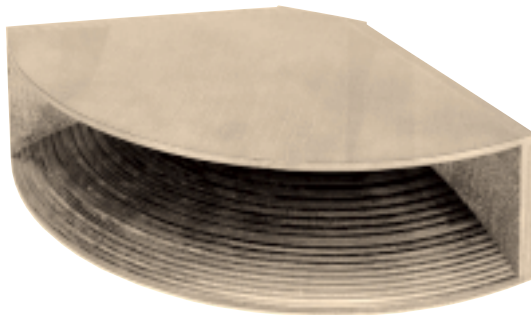

Specifications

Type	: Radial Horn
Cutoff Frequency	: 328kHz
Throat Diameter	: 25.4 mm (1 in)
Dimensions W	: 583 mm (22.95 in)
H	: 150 mm (5.905 in)
D	: 336 mm (13.22 in)
Net Weight	: 9.5 kg (20.944 lb)

H400

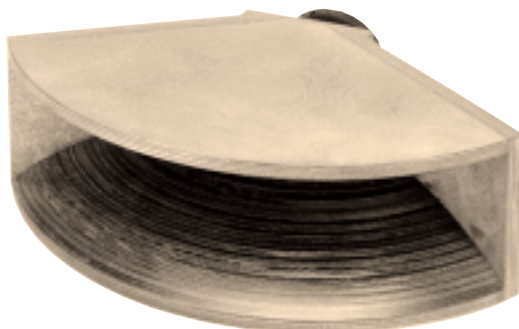

Specifications

Type	: Radial Horn
Cutoff Frequency	: 455kHz
Throat Diameter	: 25.4 mm (1 in)
Dimensions W	: 396 mm (15.59 in)
H	: 120 mm (4.72 in)
D	: 226 mm (8.897 in)
Net Weight	: 5.5 kg (12.125 lb)

H200

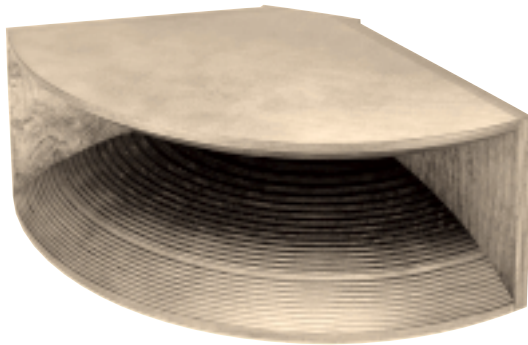

Specifications

Type	: Radial Horn
Cutoff Frequency	: 240kHz
Throat Diameter	: 50.8 mm (2 in)
Dimensions W	: 675 mm (26.57 in)
H	: 230 mm (9.05 in)
D	: 383 mm (15.07 in)
Net Weight	: 18 kg (39.683 lb)

H300

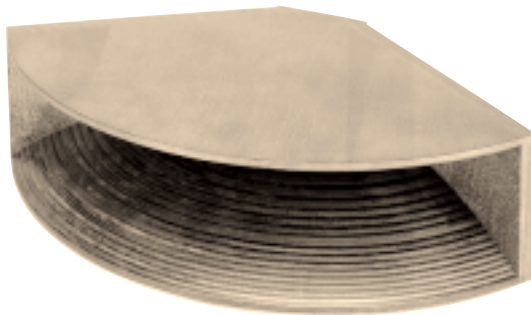

Specifications

Type	: Radial Horn
Cutoff Frequency	: 328kHz
Throat Diameter	: 25.4 mm (1 in)
Dimensions W	: 583 mm (22.95 in)
H	: 150 mm (5.905 in)
D	: 336 mm (13.22 in)
Net Weight	: 9.5 kg (20.944 lb)

H400

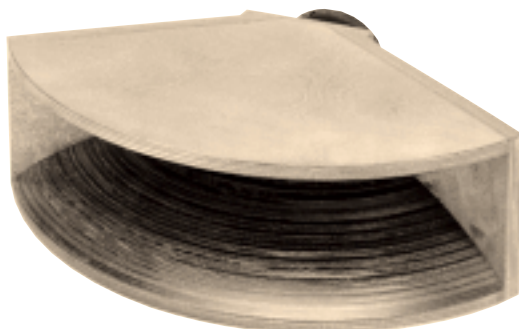

Specifications

Type	: Radial Horn
Cutoff Frequency	: 455kHz
Throat Diameter	: 25.4 mm (1 in)
Dimensions W	: 396 mm (15.59 in)
H	: 120 mm (4.72 in)
D	: 226 mm (8.897 in)
Net Weight	: 5.5 kg (12.125 lb)

H200

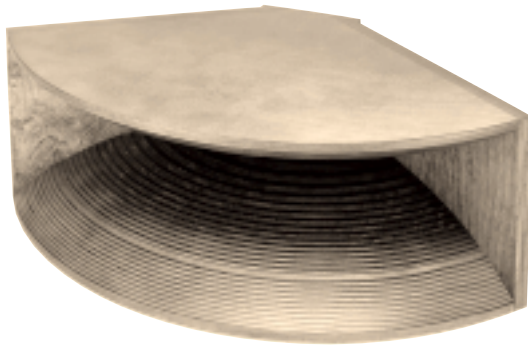

Specifications

Type	: Radial Horn
Cutoff Frequency	: 240kHz
Throat Diameter	: 50.8 mm (2 in)
Dimensions W	: 675 mm (26.57 in)
H	: 230 mm (9.05 in)
D	: 383 mm (15.07 in)
Net Weight	: 18 kg (39.683 lb)

H300

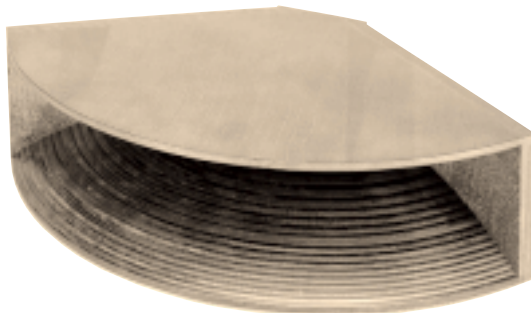

Specifications

Type	: Radial Horn
Cutoff Frequency	: 328kHz
Throat Diameter	: 25.4 mm (1 in)
Dimensions W	: 583 mm (22.95 in)
H	: 150 mm (5.905 in)
D	: 336 mm (13.22 in)
Net Weight	: 9.5 kg (20.944 lb)

H400

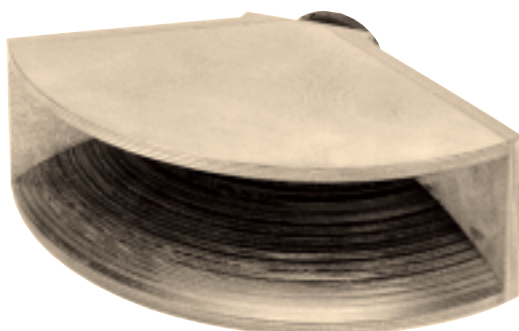

Specifications

Type	: Radial Horn
Cutoff Frequency	: 455kHz
Throat Diameter	: 25.4 mm (1 in)
Dimensions W	: 396 mm (15.59 in)
H	: 120 mm (4.72 in)
D	: 226 mm (8.897 in)
Net Weight	: 5.5 kg (12.125 lb)