

The **MLytic® HV** electrolytic capacitors have been developed from the latest materials and under utilisation of the most modern manufacturing technique especially for the requirements of tube amplifiers.

The 450 VDC-versions have an axial construction form, whereas the 500 VDC types are offered with soldering lugs. Following many classic designs, these capacitors are offered as double capacity.

In addition to the utilisation in new developments, they are also outstandingly suitable for repairs and tuning of existing amplifiers.

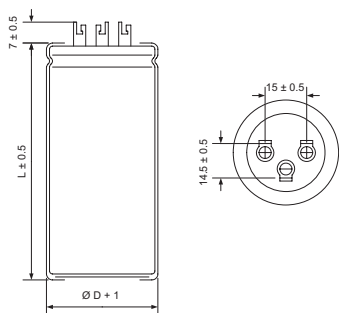
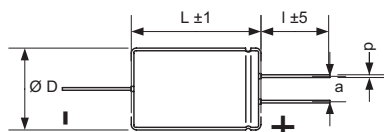

mlal4502

Electrolytic capacitors, 450 VDC, HV

Capacity [µF]-10+30%	Body Ø * L [mm]	ESR@100 Hz (typ.) [mOhm]	Rated ripple current	tan δ 100 Hz [%]	[€]
15+15	25 * 38	4.20	0.2%	4	5.99
33+33	25 * 49	2.00	0.2%	4	6.99
47+47	30 * 50	1.40	0.4%	4	9.99
100+100	35 * 50	0.60	0.7%	4	14.90

mlsl5002

Electrolytic capacitors, 500 VDC, HV

Capacity [µF]-10+30%	Body Ø * L [mm]	ESR@100 Hz (typ.) [mOhm]	Rated ripple current	tan δ 100 Hz [%]	[€]
16+16	35 * 50	5.00	0.3%	5	11.90
32+32	35 * 50	2.50	0.4%	5	12.50
40+40	35 * 50	2.00	0.4%	5	12.90
50+50	35 * 50	1.60	0.5%	5	13.50
100+100	35 * 66	0.80	0.7%	5	16.90
150+150	35 * 66	0.55	0.9%	5	19.90
200+200	35 * 80	0.40	1.1%	5	31.90

Fastening clips for capacitors, 35 mm

[€]
1.99

