

# HS 250

150+150 Watt max

8 Ω

Ø 250 mm / 10"

## SUB WOOFER

Doppia bobina mobile, membrana in cellulosa smorzata e sospensione in poliuretano

Dual coil, doped paper cone, polyurethane surround

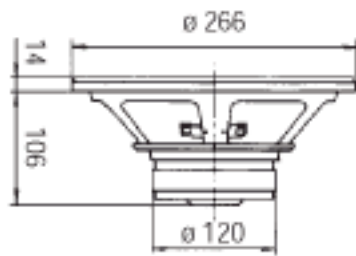

Potenza nominale 80+80 W

Re 6+6 Ω

D 208 mm

Impedenza nominale 8+8 Ω

Fs 19 Hz

Vas 194 dm<sup>3</sup>

Sensibilità (1W/1m) 86 dB

Qms 3,57

BxI 8,74 Wb/m

Ø bobina mobile 38 mm

Qes 0,26

Xmax 8 mm

Altezza traferro 8 mm

Qts 0,24

η° 0,49 %

Fori di fissaggio 8 <sup>Ø5</sup> / Ø 253

Mms 56 g

Le 0,4 mH

Foro pannello 235 mm

Cms 1,2 mm/N

Peso 2,85 Kg

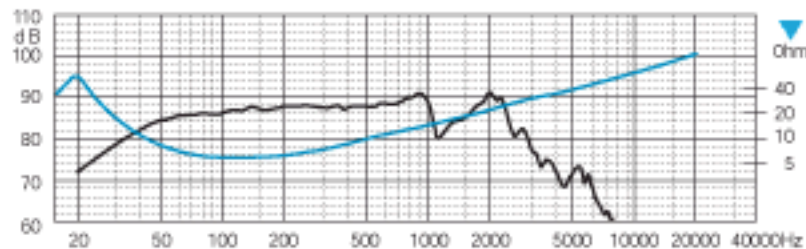

Parametri rilevati con bobine mobili in parallelo

Parameters taken with coils in parallelo