



audison

Owner's Manual
Manuale d'uso
Mode d'emploi
Bedienungsanleitung
Manual do utilizador
Manual do utilizador
Manual do utilizador

CAR POWER AMPLIFIER
AMPLIFICATEUR DE PUISSANCE POUR AUTO
AUTO-Hi-Verstärker
AMPLIFICADOR DE POTENCIA PARA COCHE
AMPLIFICADOR PARA AUTOMÓVIL
AUTO ZEŠLAVIČ

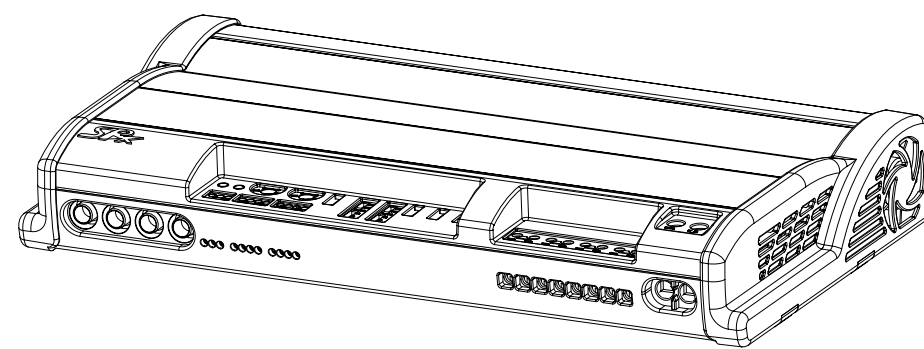

Table with 2 columns: Feature and Value. Includes sections for POWER SUPPLY, AMPLIFIER STAGE, TECHNICAL FEATURES, and OUTPUT POWER.

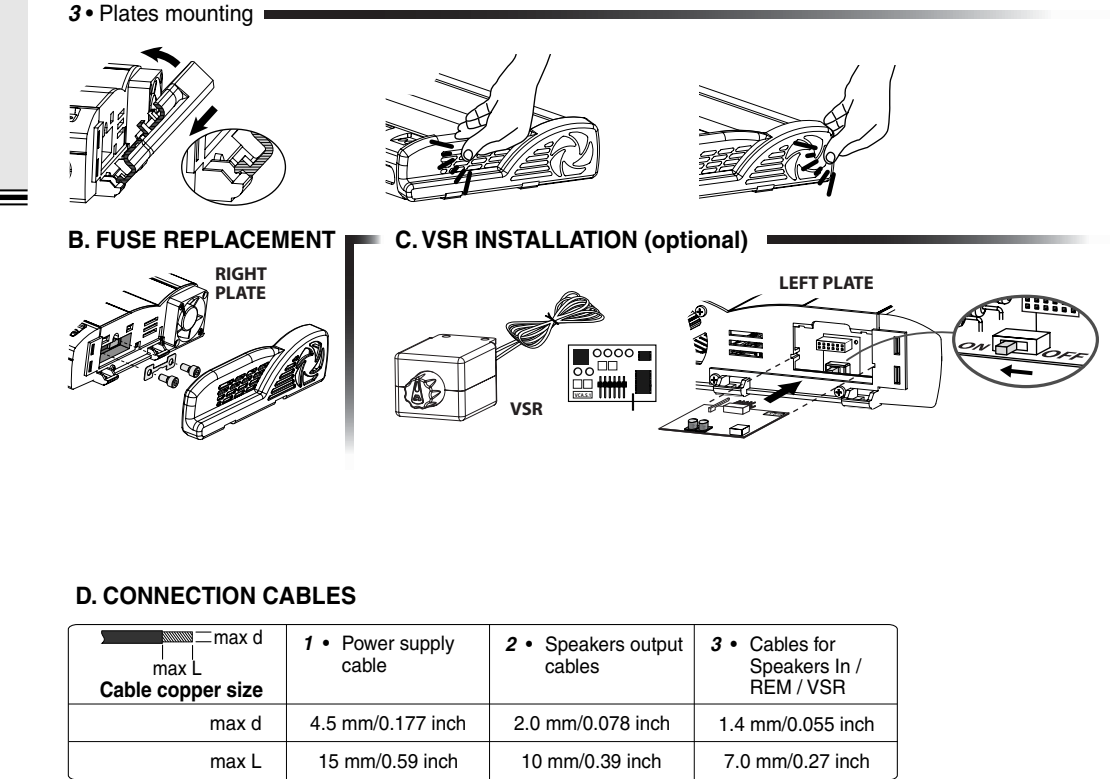

Table with 3 columns: Cable size, Power supply cable, Speakers output cables, Cables for Speakers In / REM / VSR.

CONFIGURATION TABLE with columns: Configur., Inputs, In Ch B mode, Filters mode, Out mode, Speakers Out, Pre Out.

INTRODUZIONE
Precauzioni di funzionamento
Precauzioni di sicurezza
Il progetto SRx4

INTRODUCTION
Functioning precautions
Maintenance and reliability precautions
SRx project

di.romaelectronics 62018 Potenza Picena (MC) Italy - Tel. 0733.870870 - Fax 0733.870880 - http://www.audison.com

1 INSTALLATION

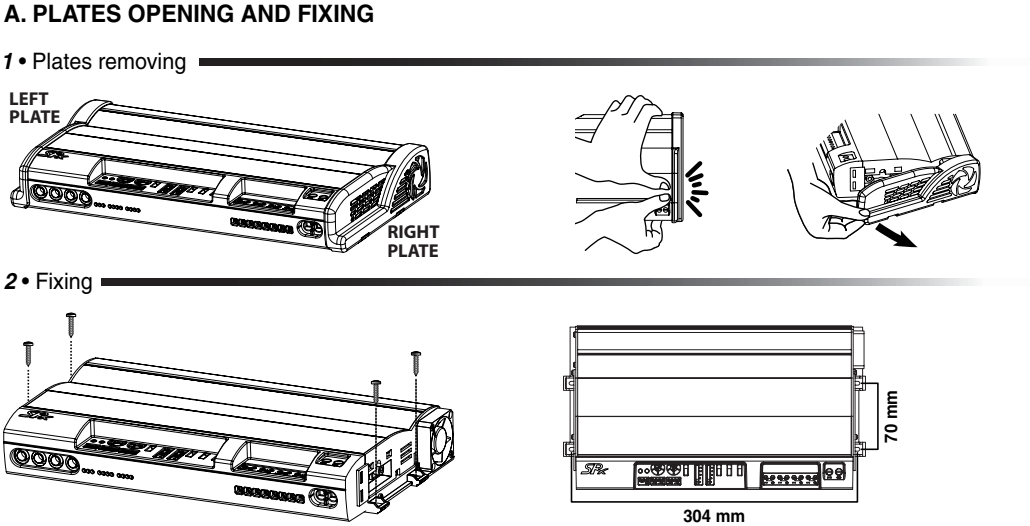

3 FUNCTIONS AND CONTROLS

- A. Levels (0.2 + 5 VRMS)
B. In Ch B Mode (In Ch B input configuration)
C. Filters adjusting
D. Filters Mode (filters configuration)
E. Out Mode (outputs configuration)
F. On/Safety (switching on / protection)

5 CONNECTIONS AND CONFIGURATIONS EXAMPLES

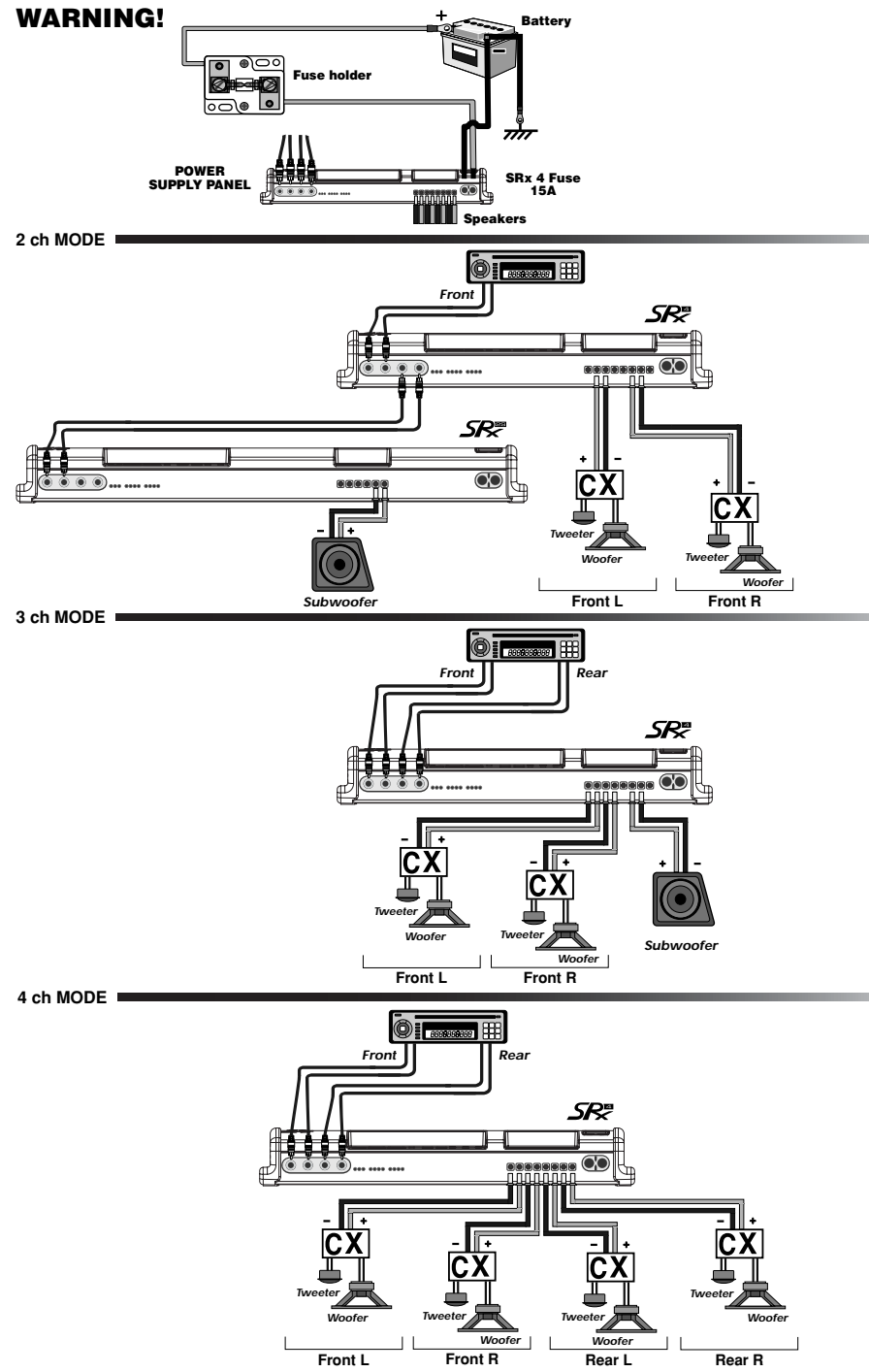

1. INSTALLAZIONE

- A. Apertura pannelli e fissaggio
B. Sostituzione del fusibile
C. Inserimento del VSR (opzionale)
D. Cavi di connessione
E. VSR (Sub volume)
F. Power

2. CONNESSIONI

- A. Pre In (ingressi preamplificati)
B. Speakers In (segnali d'ingresso amplificati)
C. Speakers Out
D. Remote In
E. VSR (Sub volume)
F. Power

3. FUNZIONI E CONTROLLI

- A. Levels (0.2 + 5 VRMS)
B. In Ch B Mode (configurazione dell'ingresso In Ch B)
C. Filters adjusting
D. Filters Mode (configurazione dei filtri)
E. Out Mode (configurazione delle uscite)
F. On / Safety (accensione / protezione)

4. TABELLA DELLE CONFIGURAZIONI

Tramite il selettore OUT MODE sono possibili tre configurazioni principali: 4 Ch (Front e Rear) per pilotare un sistema Front e Rear con uno o due ingressi; 3 Ch (Front e Sub) per pilotare un sistema...

5. COLLEGAMENTI ED ESEMPI DI CONFIGURAZIONI

ATTENZIONE! Ad ulteriore protezione dell'impianto, si consiglia di inserire un fusibile a lamina sul cavo che collega il polo positivo della batteria al morsetto +BATT dell'amplificatore.

1. INSTALLATION

- A. Plates opening and fixing
B. Fuse replacement
C. VSR installation (optional)
D. Connection cables
E. Remote In
F. Power

2. CONNECTIONS

- A. Pre In (preamplified inputs)
B. Speakers In (amplified input signals)
C. Speakers Out
D. Remote In
E. VSR (Sub volume)
F. Power

3. FUNCTIONS AND CONTROLS

- A. Levels (0.2 + 5 VRMS)
B. In Ch B Mode (In Ch B input configuration)
C. Filters adjusting
D. Filters Mode (filters configuration)
E. Out Mode (outputs configuration)
F. On / Safety (switching on / protection)

4. CONFIGURATION TABLE

Three main configurations are possible through OUT MODE switch: 4 Ch (Front and Rear) to drive a Front and Rear system with one or two inputs; 3 Ch (Front and Sub) to drive a Front and a subwoofer with one or two inputs; 2 Ch to drive a high power stereo system with two subwoofers.

5. CONNECTIONS AND CONFIGURATIONS EXAMPLES

WARNING! For extra protection, we recommend to put a strip fuse along the cable that connects the battery positive pole to the amplifier +BATT terminal. This fuse must be installed approx. 10 cm far from the battery. Its value will have to be the same as the amplifier built-in one.

